

索引圖 Key Plan

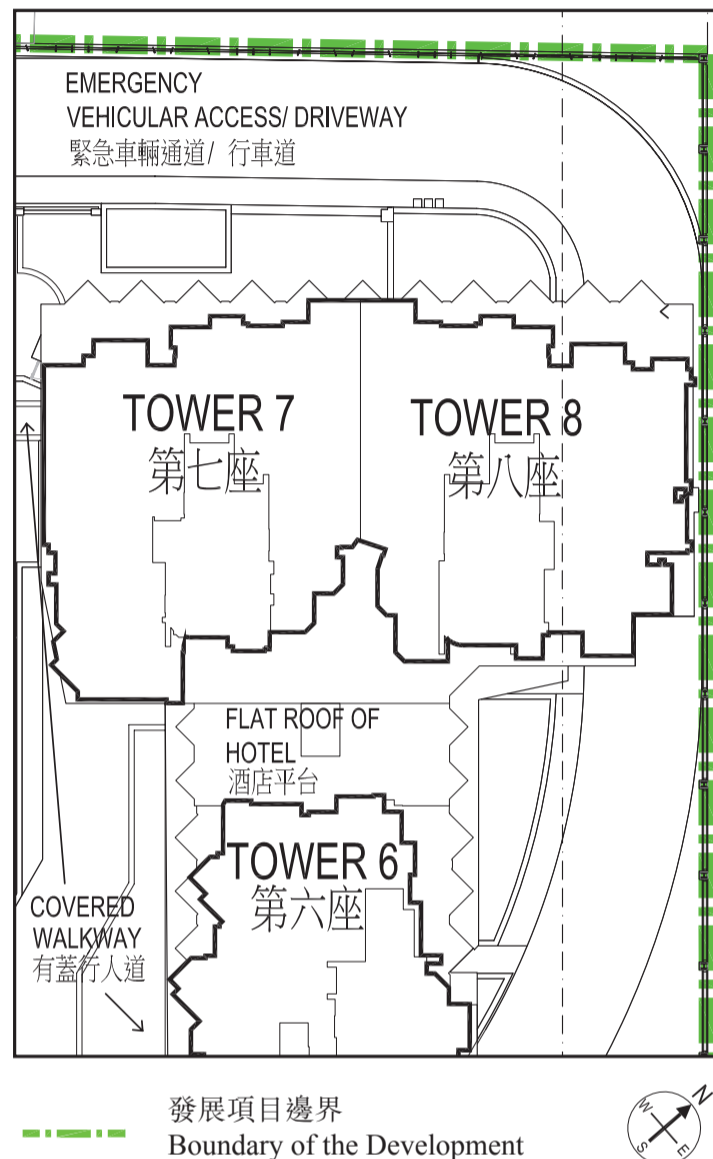

每個住宅物業的樓板(不包括灰泥)的厚度：150毫米(適用於第7座7樓A單位)；125毫米及150毫米(適用於第7座7樓B單位)

The thickness of the floor slabs (excluding plaster) of each residential property: 150mm (applicable to Unit A on 7/F of Tower 7); 125mm and 150mm (applicable to Unit B on 7/F of Tower 7)

每個住宅物業的層與層之間的高度：2.975米及2.975米*

* 包括本層地台跌級樓板上之輕質混凝土填充層厚度。

The floor-to-floor height of each residential property: 2.975m and 2.975m*

* Inclusive of the thickness of light-weight concrete fill on sunken slab on the floor of this floor.

因住宅物業的較高樓層的結構牆的厚度遞減，較高樓層的內部面積，一般比較低樓層的內部面積稍大。

(不適用於本發展項目)

The internal areas of the residential properties on the upper floors will generally be slightly larger than those on the lower floors because of the reducing thickness of the structural walls on the upper floors.

(Not applicable to the Development)

備註：

- 1) 以上樓面平面圖中顯示之名詞及簡稱之詞彙表請參閱「發展項目的住宅物業的樓面平面圖」一節首頁。
- 2) 第1、7及8座住宅樓層不設13樓、14樓及24樓。第3、5及6座住宅樓層不設13樓、14樓、24樓及34樓。第3及5座19樓為庇護層。

Remarks:

- 1) Please refer to the first page of the section "Floor Plans of Residential Properties in the Development" for glossary of the terms and abbreviations shown in the floor plan above.
- 2) Residential floors 13/F, 14/F and 24/F of Towers 1, 7 and 8 are omitted. Residential floors 13/F, 14/F, 24/F and 34/F of Towers 3, 5 and 6 are omitted. 19/F of Towers 3 and 5 is refuge floor.