

FLOOR PLANS OF PARKING SPACES IN THE PHASE 期數中的停車位的樓面平面圖

B2/F 地庫2層



--- Boundary of the Development
發展項目的界線



Scale: 0M/米 25M/米
比例: 1:2500

NUMBERS, DIMENSIONS AND AREA OF PARKING SPACES ON B2/F 地庫2層的車位數目、尺寸及面積

Category of Parking Space 停車位類別	Number 數目	Dimension (L x W) (m) 尺寸 (長 x 寬) (米)	Area Per Parking Space (sq.m.) 每個停車位面積 (平方米)
Residential Car Parking Space 住客停車位	77	5 x 2.5	12.5
Residential Car Parking Space for Disabled Person 傷健人士住客停車位	1	5 x 3.5	17.5
Residential Motor Cycle Parking Space 住客電單車停車位	4	2.4 x 1	2.4
Visitor Car Parking Space 訪客停車位	9	5 x 2.5	12.5
Visitor Car Parking Space for Disabled Person 傷健人士訪客停車位	1	5 x 3.5	17.5
Residential Loading and Unloading Space 住客上落貨停車位	2	11 x 3.5	38.5

FLOOR PLANS OF PARKING SPACES IN THE PHASE 期數中的停車位的樓面平面圖

B1/F 地庫1層

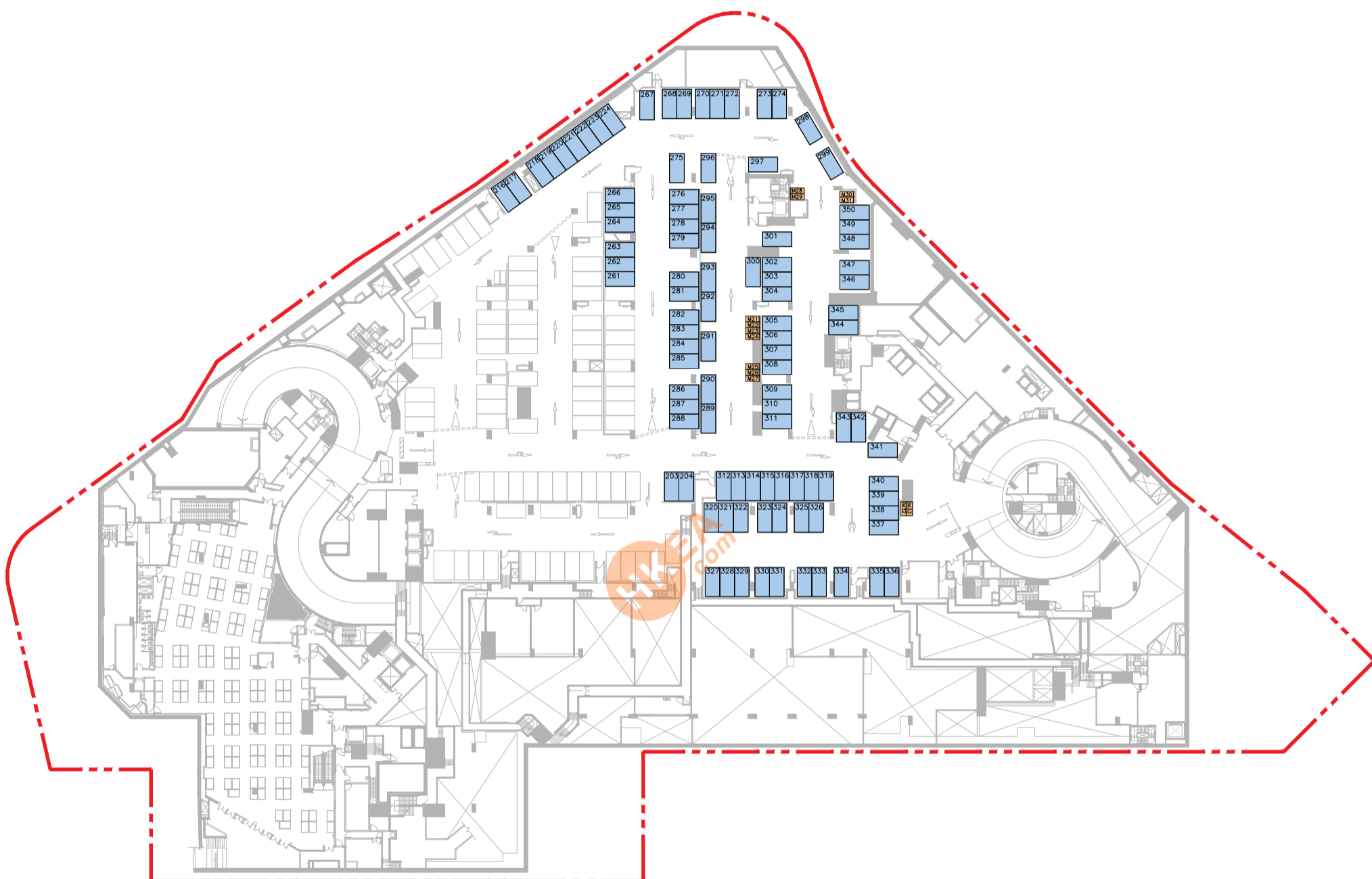

--- Boundary of the Development
發展項目的界線

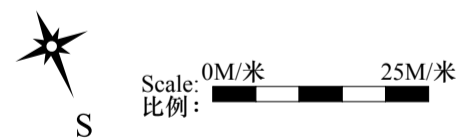

NUMBERS, DIMENSIONS AND AREA OF PARKING SPACES ON B1/F 地庫1層的車位數目、尺寸及面積

Category of Parking Space 停車位類別	Number 數目	Dimension (L x W) (m) 尺寸 (長 x 寬) (米)	Area Per Parking Space (sq.m.) 每個停車位面積 (平方米)
Residential Car Parking Space 住客停車位	101	5 x 2.5	12.5
Residential Motor Cycle Parking Space 住客電單車停車位	13	2.4 x 1	2.4