

8. OUTLINE ZONING PLAN ETC. RELATING TO THE DEVELOPMENT 關乎發展項目的分區計劃大綱圖等

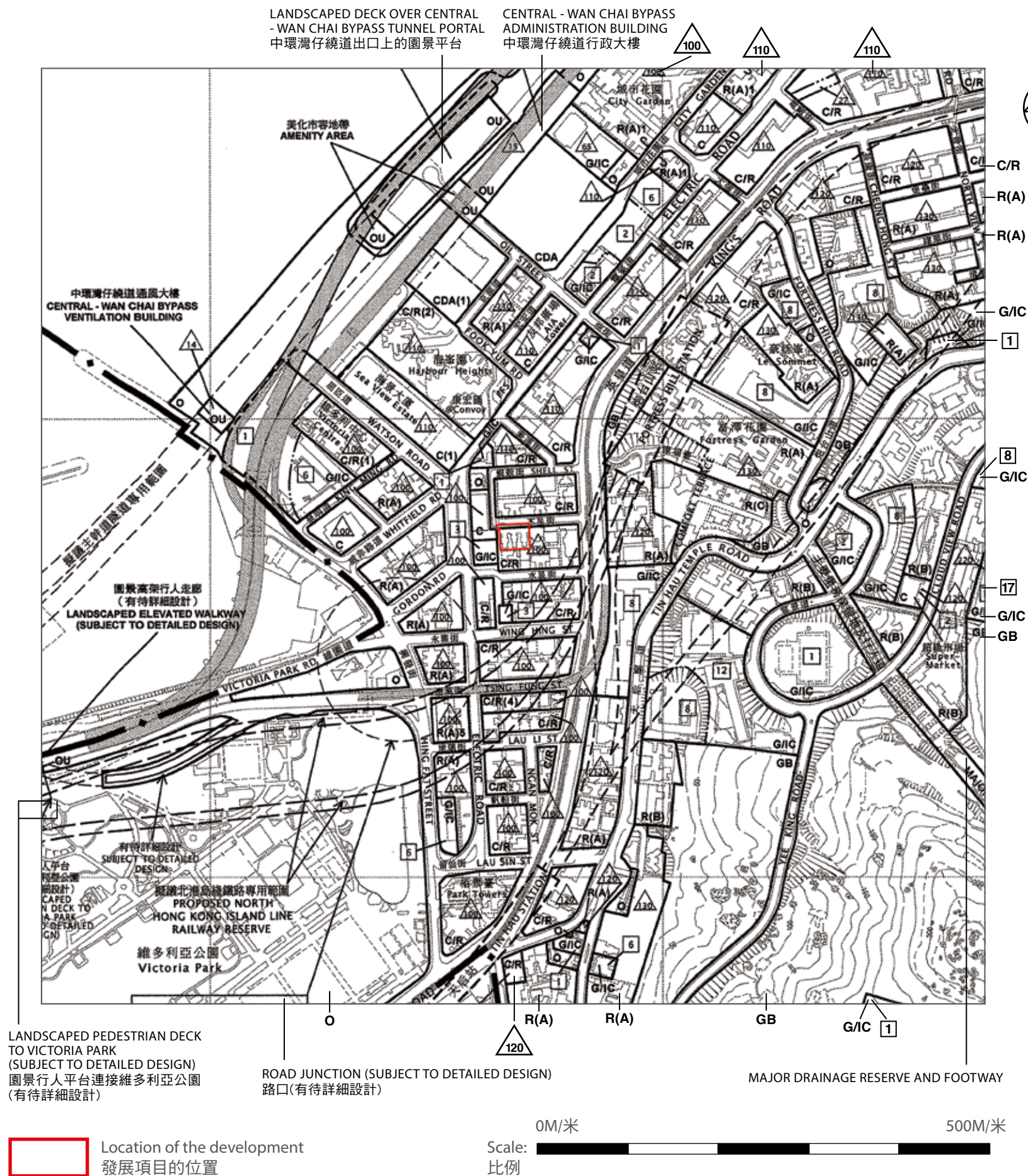

Extracted from the approved North Point (Hong Kong Planning Area No. 8) Outline Zoning Plan, Plan No. S/H8/26, gazetted on 25th August 2017, with adjustments where necessary.

摘錄自2017年8月25日刊憲之北角(港島規劃區第8區)分區計劃大綱核准圖，圖則編號為S/H8/26，經修正處理。

NOTATION 圖例

ZONES 地帶

C	COMMERCIAL 商業
CDA	COMPREHENSIVE DEVELOPMENT AREA 綜合發展區
C/R	COMMERCIAL / RESIDENTIAL 商業/住宅
R(A)	RESIDENTIAL (GROUP A) 住宅(甲類)
R(B)	RESIDENTIAL (GROUP B) 住宅(乙類)
R(C)	RESIDENTIAL (GROUP C) 住宅(丙類)
G/IC	GOVERNMENT, INSTITUTION OR COMMUNITY 政府、機構或社區
O	OPEN SPACE 休憩用地
OU	OTHER SPECIFIED USES 其他指定用途
GB	GREEN BELT 綠化地帶

COMMUNICATIONS 交通

	RAILWAY AND STATION (UNDERGROUND) 鐵路及車站(地下)
	MAJOR ROAD AND JUNCTION 主要道路及路口
	ELEVATED ROAD 高架道路
	RAILWAY RESERVE 鐵路專用範圍

MISCELLANEOUS 其他

	BOUNDARY OF PLANNING SCHEME 規劃範圍界線
	BUILDING HEIGHT CONTROL ZONE BOUNDARY 建築物高度管制區界線
	MAXIMUM BUILDING HEIGHT (IN METRES ABOVE PRINCIPAL DATUM) 最高建築物高度(在主水平基準上若干米)
	MAXIMUM BUILDING HEIGHT (IN NUMBER OF STOREYS) 最高建築物高度(樓層數目)

Note: Due to technical reasons, this outline zoning plan has shown more than the area required under the Residential Properties (First-hand Sales) Ordinance.

備註: 因技術性問題，此分區計劃大綱圖所顯示的範圍超過《一手住宅物業銷售條例》的規定。

8. OUTLINE ZONING PLAN ETC. RELATING TO THE DEVELOPMENT 關乎發展項目的分區計劃大綱圖等

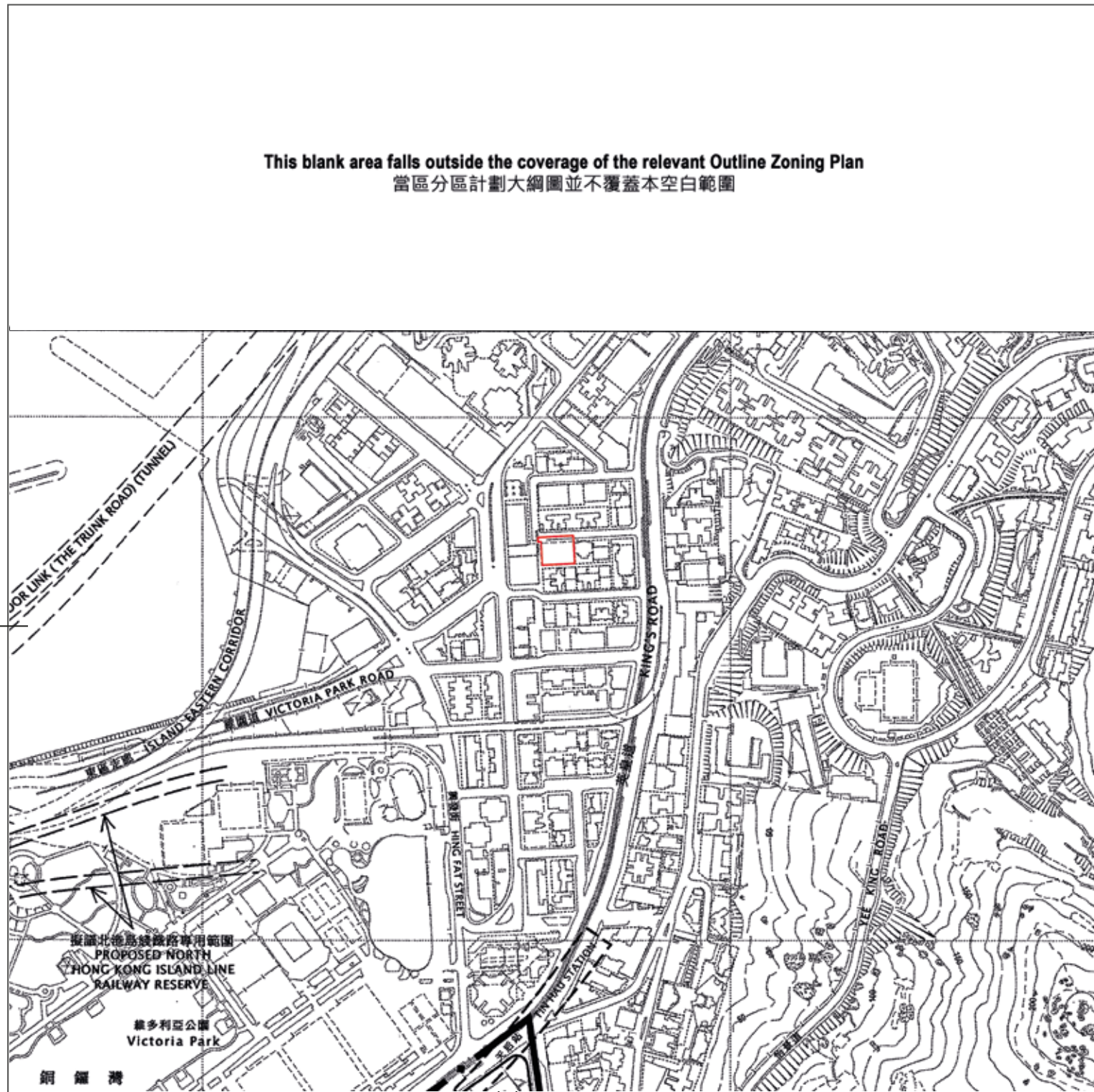

This blank area falls outside the coverage of the relevant Outline Zoning Plan
 當區分區計劃大綱圖並不覆蓋本空白範圍

CENTRAL-WAN CHAI BYPASS AND ISLAND EASTERN CORRIDOR LINK
 (THE TRUNK ROAD) (TUNNEL)
 中環及灣仔繞道和東區走廊連接路(主幹道)(隧道)

G/IC 8

Location of the development
 發展項目的位置



Extracted from the approved Causeway Bay (Hong Kong Planning Area No. 6) Outline Zoning Plan, Plan No. S/H6/17, gazetted on 18th January 2019, with adjustments where necessary.

摘錄自2019年1月18日刊憲之銅鑼灣(港島規劃區第6區)分區計劃大綱核准圖，圖則編號為S/H6/17，經修正處理。

NOTATION 圖例

ZONES 地帶

G/IC GOVERNMENT, INSTITUTION OR COMMUNITY 政府、機構或社區

COMMUNICATIONS 交通

RAILWAY AND STATION (UNDERGROUND) 鐵路及車站(地下)

MAJOR ROAD AND JUNCTION 主要道路及路口

RAILWAY RESERVE 鐵路專用範圍

MISCELLANEOUS 其他

BOUNDARY OF PLANNING SCHEME 規劃範圍界線

BUILDING HEIGHT CONTROL ZONE BOUNDARY
 建築物高度管制區界線

8 MAXIMUM BUILDING HEIGHT (IN NUMBER OF STOREYS)
 最高建築物高度(樓層數目)

Note: Due to technical reasons, this outline zoning plan has shown more than the area required under the Residential Properties (First-hand Sales) Ordinance.

備註: 因技術性問題，此分區計劃大綱圖所顯示的範圍超過《一手住宅物業銷售條例》的規定。

8. OUTLINE ZONING PLAN ETC. RELATING TO THE DEVELOPMENT 關乎發展項目的分區計劃大綱圖等

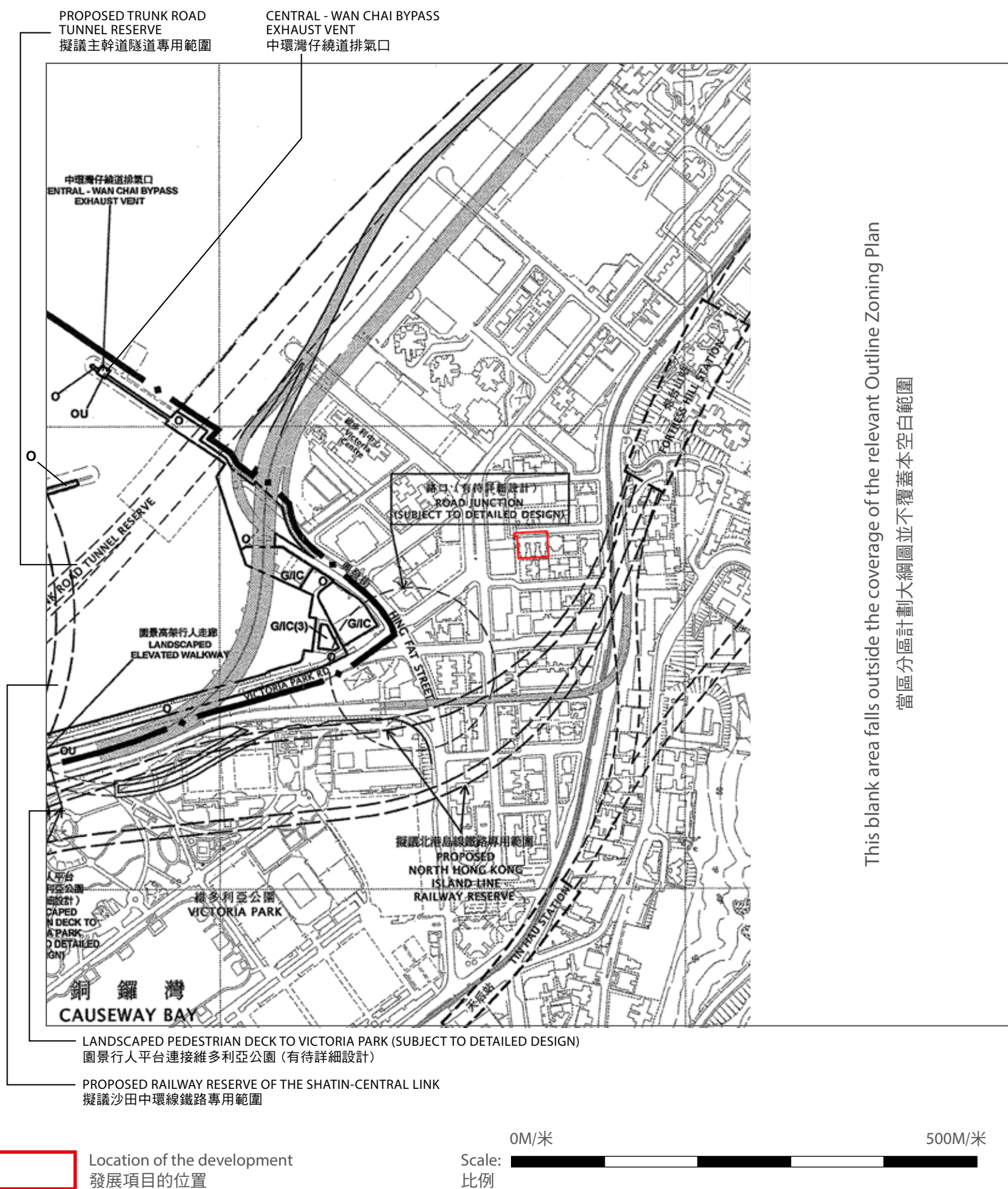

This blank area falls outside the coverage of the relevant Outline Zoning Plan
 當區分區計劃大綱圖並不覆蓋本空白範圍



Extracted from the approved Wan Chai North (Hong Kong Planning Area No. 25) Outline Zoning Plan, Plan No. S/H25/4, gazetted on 28th February 2014, with adjustments where necessary.

摘錄自2014年2月28日刊憲之灣仔北(港島規劃區第25區)分區計劃大綱核准圖，圖則編號為S/H25/4，經修正處理。

NOTATION 圖例

ZONES 地帶

G/IC	GOVERNMENT, INSTITUTION OR COMMUNITY 政府、機構或社區
O	OPEN SPACE 休憩用地
OU	OTHER SPECIFIED USES 其他指定用途

COMMUNICATIONS 交通

	RAILWAY AND STATION (UNDERGROUND) 鐵路及車站 (地下)
	MAJOR ROAD AND JUNCTION 主要道路及路口
	ELEVATED ROAD 高架道路
	RAILWAY RESERVE 鐵路專用範圍

MISCELLANEOUS 其他

	BOUNDARY OF PLANNING SCHEME 規劃範圍界線
--	------------------------------------

Note: Due to technical reasons, this outline zoning plan has shown more than the area required under the Residential Properties (First-hand Sales) Ordinance.

備註：因技術性問題，此分區計劃大綱圖所顯示的範圍超過《一手住宅物業銷售條例》的規定。