

# OUTLINE ZONING PLAN ETC. RELATING TO THE DEVELOPMENT 關乎發展項目的分區計劃大綱圖等

The Outline Zoning Plan is adopted from part of the Kowloon Planning Area No. 14 (PART) – Approved Kwun Tong (South) Outline Zoning Plan No. S/K14S/22 gazetted on 9th November, 2018.

The Outline Zoning Plan is reproduced with permission of the Director of Lands. ©The Government of Hong Kong SAR.

分區計劃大綱圖摘錄自2018年11月9日憲報公布之觀塘南部(九龍規劃區第14區部分)分區計劃大綱核准圖(編號S/K14S/22)。

分區計劃大綱圖版權屬香港特區政府，經地政總署准許複印。

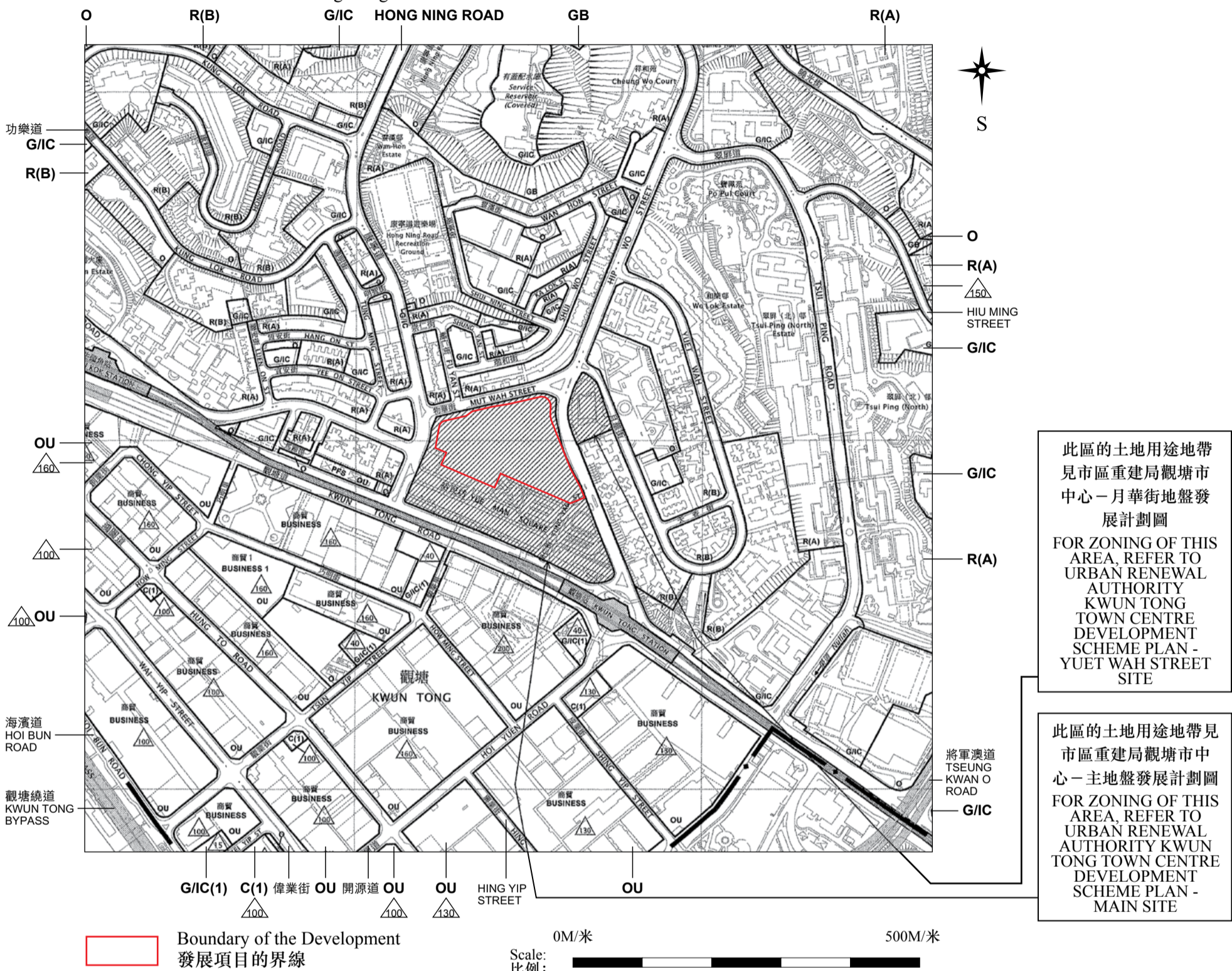

此區的土地用途地帶見市區重建局觀塘市中心—月華街地盤發展計劃圖  
 FOR ZONING OF THIS AREA, REFER TO URBAN RENEWAL AUTHORITY KWUN TONG TOWN CENTRE DEVELOPMENT SCHEME PLAN - YUET WAH STREET SITE

此區的土地用途地帶見市區重建局觀塘市中心—主地盤發展計劃圖  
 FOR ZONING OF THIS AREA, REFER TO URBAN RENEWAL AUTHORITY KWUN TONG TOWN CENTRE DEVELOPMENT SCHEME PLAN - MAIN SITE

Boundary of the Development  
 發展項目的界線

0M/米 500M/米  
 Scale: 比例:

## Notation 圖例

### Zones 地帶

|   |   |
|---|---|
| Commercial 商業                                 | <span style="border: 1px solid black; padding: 2px;">C</span>     |
| Residential(Group A) 住宅(甲類)                   | <span style="border: 1px solid black; padding: 2px;">R(A)</span>  |
| Residential(Group B) 住宅(乙類)                   | <span style="border: 1px solid black; padding: 2px;">R(B)</span>  |
| Government, Institution Or Community 政府、機構或社區 | <span style="border: 1px solid black; padding: 2px;">G/I/C</span> |
| Open Space 休憩用地                               | <span style="border: 1px solid black; padding: 2px;">O</span>     |
| Other Specified Uses 其他指定用途                   | <span style="border: 1px solid black; padding: 2px;">OU</span>    |
| Green Belt 綠化地帶                               | <span style="border: 1px solid black; padding: 2px;">GB</span>    |

### Communications 交通

|  |  |
|--|--|
| Railway And Station (Elevated) 鐵路及車站(高架) |  |
| Major Road And Junction 主要道路及路口          |  |
| Elevated Road 高架道路                       |  |

### Miscellaneous 其他

|   |  |
|---|--|
| Boundary Of Planning Scheme 規劃範圍界線                                |  |
| Urban Renewal Authority Development Scheme Plan Area 市區重建局發展計劃圖範圍 |  |

### Miscellaneous 其他

|  |       |
|--|-------|
| Building Height Control Zone Boundary 建築物高度管制區界線                               |       |
| Maximum Building Height (In Meters Above Principal Datum) 最高建築物高度 (在主水平基準上若干米) |       |
| Petrol Filling Station 加油站   | P F S |

### Remarks:

- Due to technical reasons (such as the shape of the Development), the Outline Zoning Plan has shown more than the area required under the Residential Properties (First-hand Sales) Ordinance (Cap.621).
- The Vendor advises prospective purchasers to conduct an on-site visit for a better understanding of the Development, its surrounding environment and the public facilities nearby.

### 備註:

- 因技術原因(例如發展項目之形狀)，分區計劃大綱圖所顯示之範圍超過《一手住宅物業銷售條例》(第621章)所要求者。
- 賣方建議準買家到發展項目作實地考察，以對發展項目、其周邊地區環境及附近的公共設施有較佳了解。



# OUTLINE ZONING PLAN ETC. RELATING TO THE DEVELOPMENT 關乎發展項目的分區計劃大綱圖等

The Outline Zoning Plan is adopted from part of the Kowloon Planning Area No.15 - Approved Cha Kwo Ling, Yau Tong, Lei Yue Mun Outline Zoning Plan No. S/K15/25 gazetted on 28th April 2017.

The Outline Zoning Plan is reproduced with permission of the Director of Lands. ©The Government of Hong Kong SAR.

分區計劃大綱圖摘錄自2017年4月28日憲報公布之茶果嶺、油塘及鯉魚門(九龍規劃區第15區)分區計劃大綱核准圖(編號S/K15/25)。

分區計劃大綱圖版權屬香港特區政府，經地政總署准許複印。

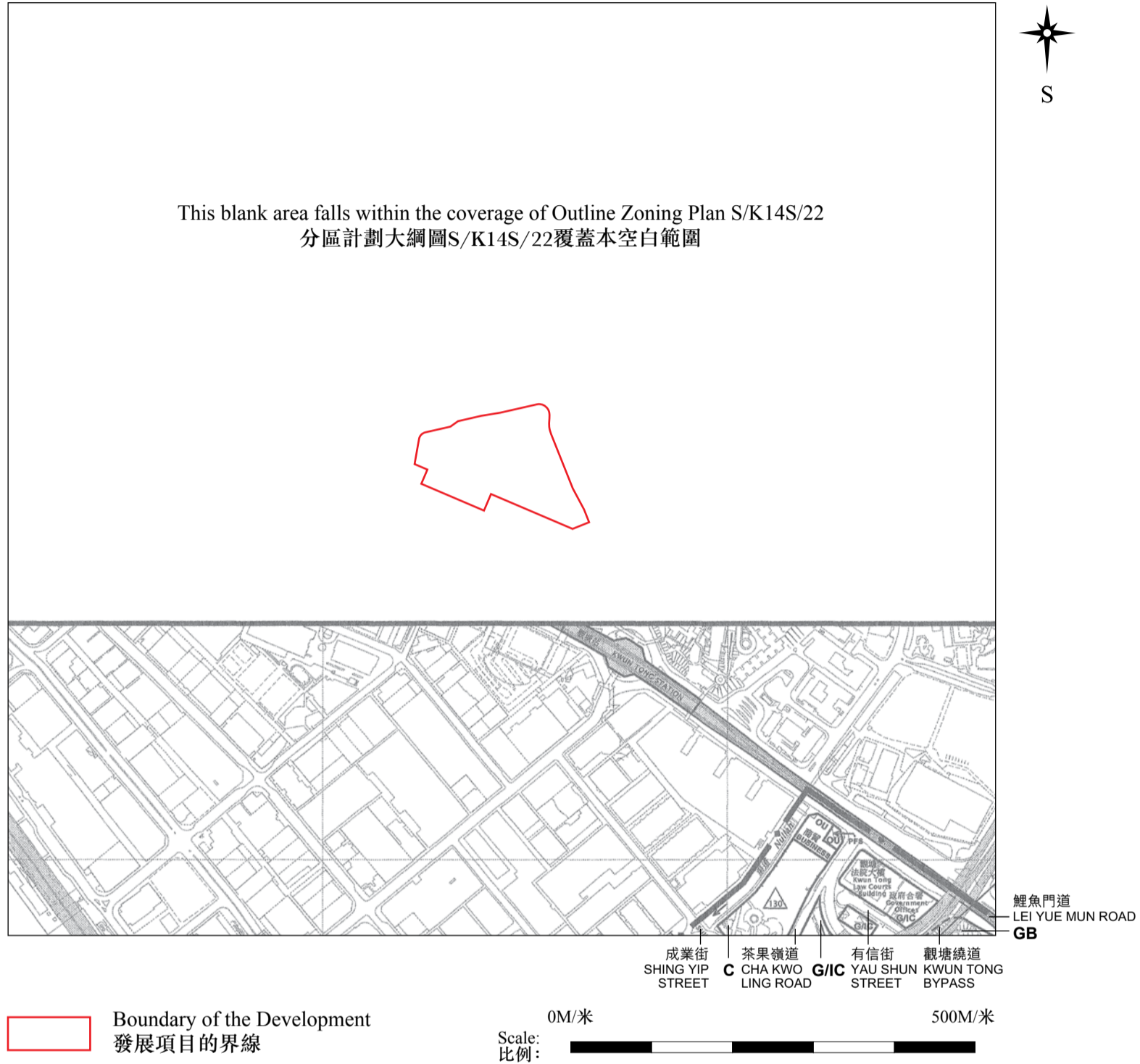

Boundary of the Development  
 發展項目的界線

Scale: 0M/米 500M/米  
 比例:

## Notation 圖例

### Zones 地帶

|   |  |
|---|--|
| Commercial 商業                                 | <span style="border: 1px solid black; padding: 2px 5px;">C</span>    |
| Government, Institution Or Community 政府、機構或社區 | <span style="border: 1px solid black; padding: 2px 5px;">G/IC</span> |
| Other Specified Uses 其他指定用途                   | <span style="border: 1px solid black; padding: 2px 5px;">OU</span>   |
| Green Belt 綠化地帶                               | <span style="border: 1px solid black; padding: 2px 5px;">GB</span>   |

### Communications 交通

|  |  |
|--|--|
| Railway And Station (Elevated) 鐵路及車站(高架) |  |
| Major Road And Junction 主要道路及路口          |  |
| Elevated Road 高架道路                       |  |

### Miscellaneous 其他

|  |       |
|--|-------|
| Boundary Of Planning Scheme 規劃範圍界線   |       |
| Maximum Building Height (In Meters Above Principal Datum) 最高建築物高度 (在主水平基準上若干米) |       |
| Petrol Filling Station 加油站   | P F S |

### Remarks:

- Due to technical reasons (such as the shape of the Development), the Outline Zoning Plan has shown more than the area required under the Residential Properties (First-hand Sales) Ordinance (Cap.621).
- The Vendor advises prospective purchasers to conduct an on-site visit for a better understanding of the Development, its surrounding environment and the public facilities nearby.

### 備註:

- 因技術原因(例如發展項目之形狀)，分區計劃大綱圖所顯示之範圍超過《一手住宅物業銷售條例》(第621章)所要求者。
- 賣方建議準買家到發展項目作實地考察，以對發展項目、其周邊地區環境及附近的公共設施有較佳了解。

# OUTLINE ZONING PLAN ETC. RELATING TO THE DEVELOPMENT 關乎發展項目的分區計劃大綱圖等

The Outline Zoning Plan is adopted from part of the Kowloon Planning Area No. 22 (PART) – Approved Kai Tak Outline Zoning Plan No. S/K22/6 gazetted on 25th May, 2018.

The Outline Zoning Plan is reproduced with permission of the Director of Lands. ©The Government of Hong Kong SAR.

分區計劃大綱圖摘錄自2018年5月25日憲報公布之啟德(九龍規劃區第22區部分)分區計劃大綱核准圖(編號S/K22/6)。

分區計劃大綱圖版權屬香港特區政府，經地政總署准許複印。

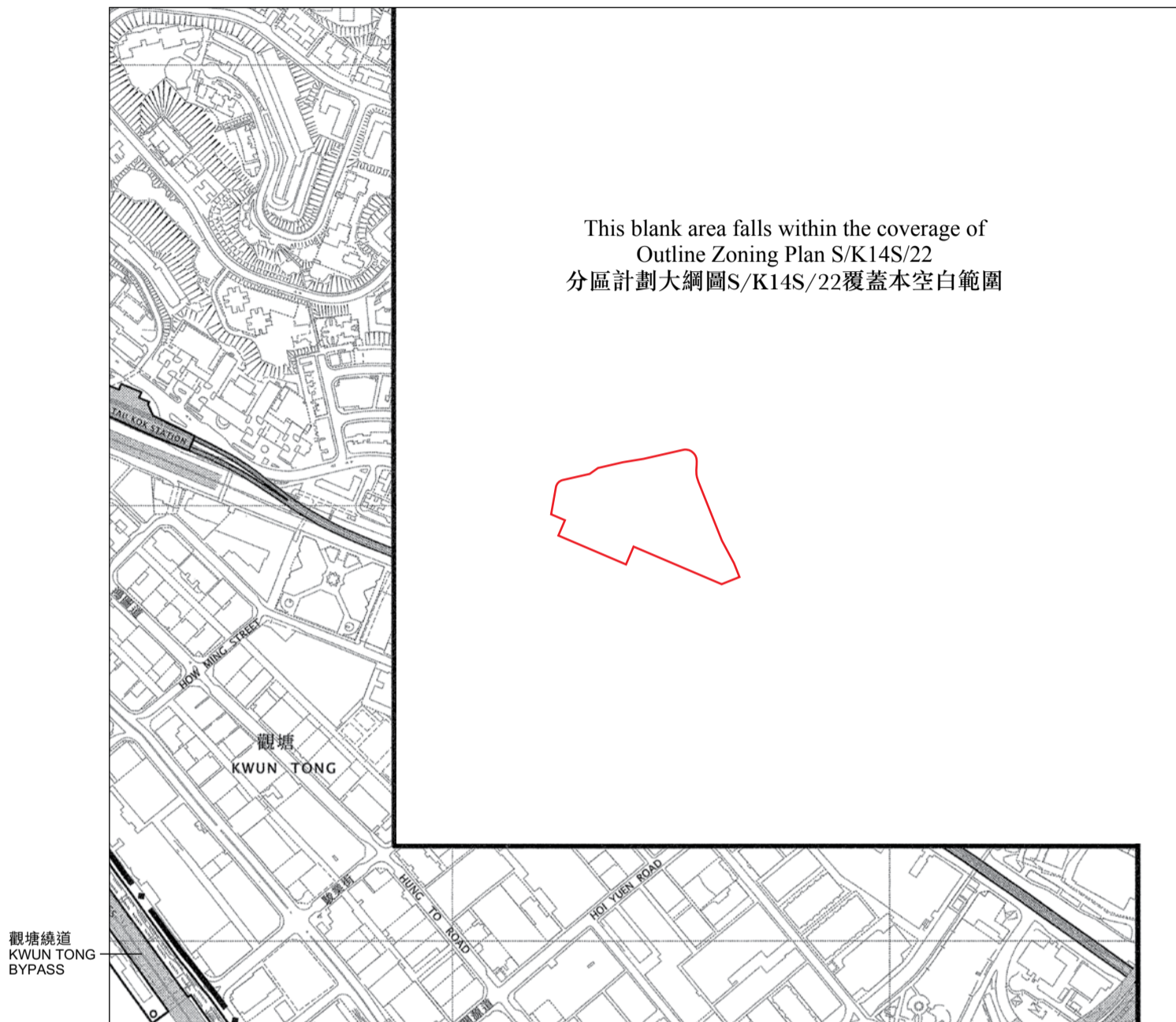

This blank area falls within the coverage of  
 Outline Zoning Plan S/K14S/22  
 分區計劃大綱圖S/K14S/22覆蓋本空白範圍

觀塘繞道  
 KWUN TONG  
 BYPASS

 Boundary of the Development  
 發展項目的界線

Scale: 0M/米 500M/米  
 比例: 

## Notation 圖例

### Zones 地帶

Open Space 休憩用地

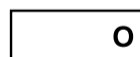

### Communications 交通

Railway And Station (Elevated)  
 鐵路及車站(高架)



Major Road And Junction  
 主要道路及路口

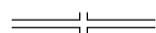

Elevated Road 高架道路



### Miscellaneous 其他

Boundary Of Planning Scheme  
 規劃範圍界線



### Remarks:

1. Due to technical reasons (such as the shape of the Development), the Outline Zoning Plan has shown more than the area required under the Residential Properties (First-hand Sales) Ordinance (Cap.621).
2. The Vendor advises prospective purchasers to conduct an on-site visit for a better understanding of the Development, its surrounding environment and the public facilities nearby.

### 備註:

1. 因技術原因(例如發展項目之形狀)，分區計劃大綱圖所顯示之範圍超過《一手住宅物業銷售條例》(第621章)所要求者。
2. 賣方建議準買家到發展項目作實地考察，以對發展項目、其周邊地區環境及附近的公共設施有較佳了解。



# OUTLINE ZONING PLAN ETC. RELATING TO THE DEVELOPMENT 關乎發展項目的分區計劃大綱圖等

The Development Scheme Plan is adopted from the Urban Renewal Authority Kwun Tong Town Centre Development Scheme Plan - Main Site (Plan No. S/K14S/URA1/2) gazetted on 12 September, 2008.

The Development Scheme Plan - Land Use Diagram is reproduced with permission of the Director of Lands ©The Government of Hong Kong SAR.

發展計劃圖摘錄自2008年9月12日憲報公布之市區重建局觀塘市中心 - 主地盤發展計劃圖 (編號 S/K14S/URA1/2)

發展計劃圖 - 土地用途圖表版權屬香港特區政府，經地政總署准許複印。

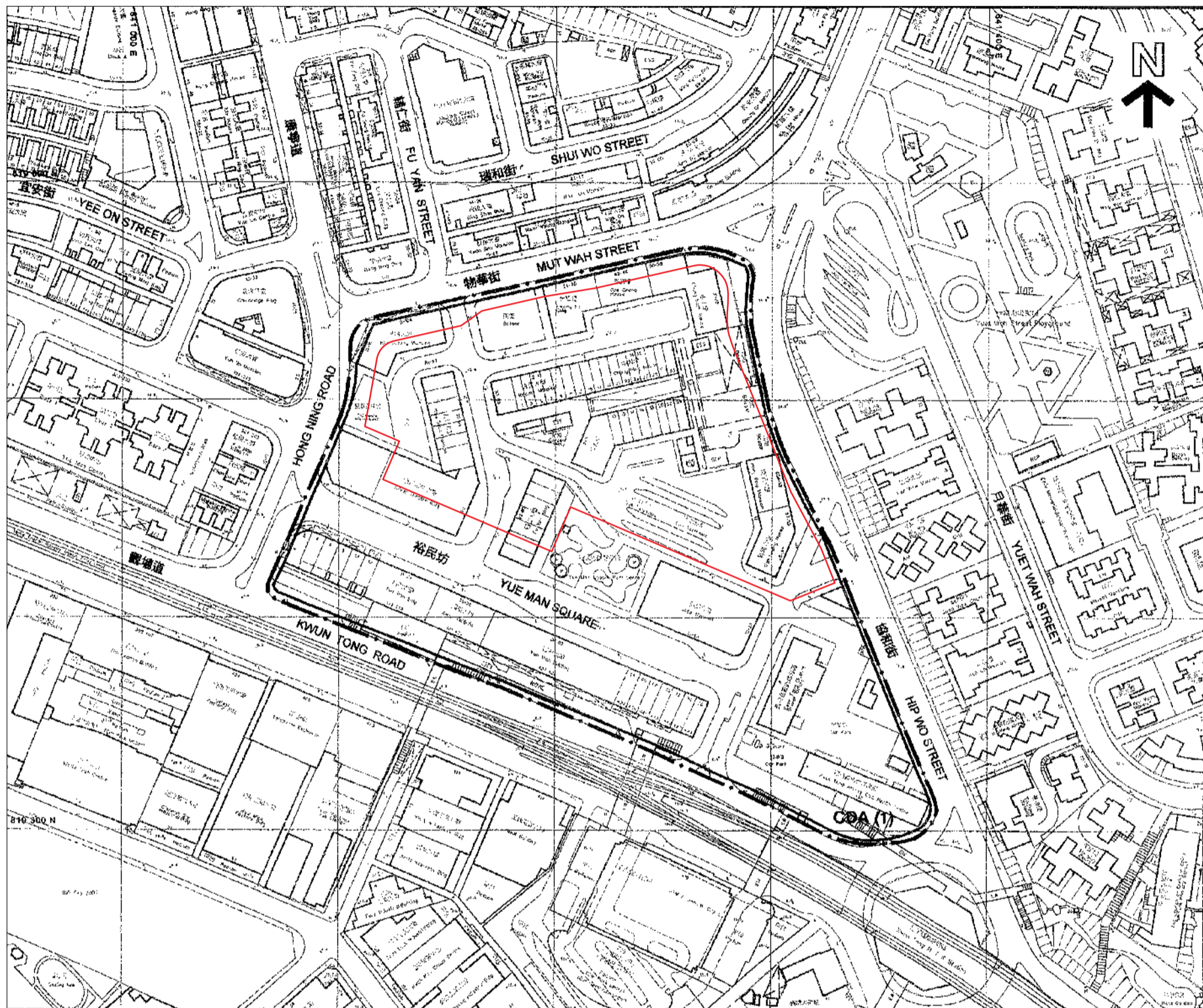

 Boundary of the Development  
 發展項目的界線

0M/米 120M/米  
 Scale: 比例: 

## Notation 圖例

Boundary of Development Scheme  
 發展計劃範圍界線 

Comprehensive Development (1)  
 綜合發展區(1) 

## Remarks:

1. The Vendor advises prospective purchasers to conduct an on-site visit for a better understanding of the Development, its surrounding environment and the public facilities nearby.

## 備註:

1. 賣方建議準買家到發展項目作實地考察，以對發展項目、其周邊地區環境及附近的公共設施有較佳了解。



# OUTLINE ZONING PLAN ETC. RELATING TO THE DEVELOPMENT 關乎發展項目的分區計劃大綱圖等

The Development Scheme Plan is adopted from the Urban Renewal Authority Kwun Tong Town Centre Development Scheme Plan - Yueh Wah Street Site. (Plan No. S/K14S/URA2/2) gazetted on 12 September, 2008.

The Development Scheme Plan - Land Use Diagram is reproduced with permission of the Director of Lands ©The Government of Hong Kong SAR.

發展計劃圖摘錄自2008年9月12日憲報公布之市區重建局觀塘市中心 - 月華街地盤發展計劃圖 (編號 S/K14S/URA2/2)

發展計劃圖 - 土地用途圖表版權屬香港特區政府，經地政總署准許複印。

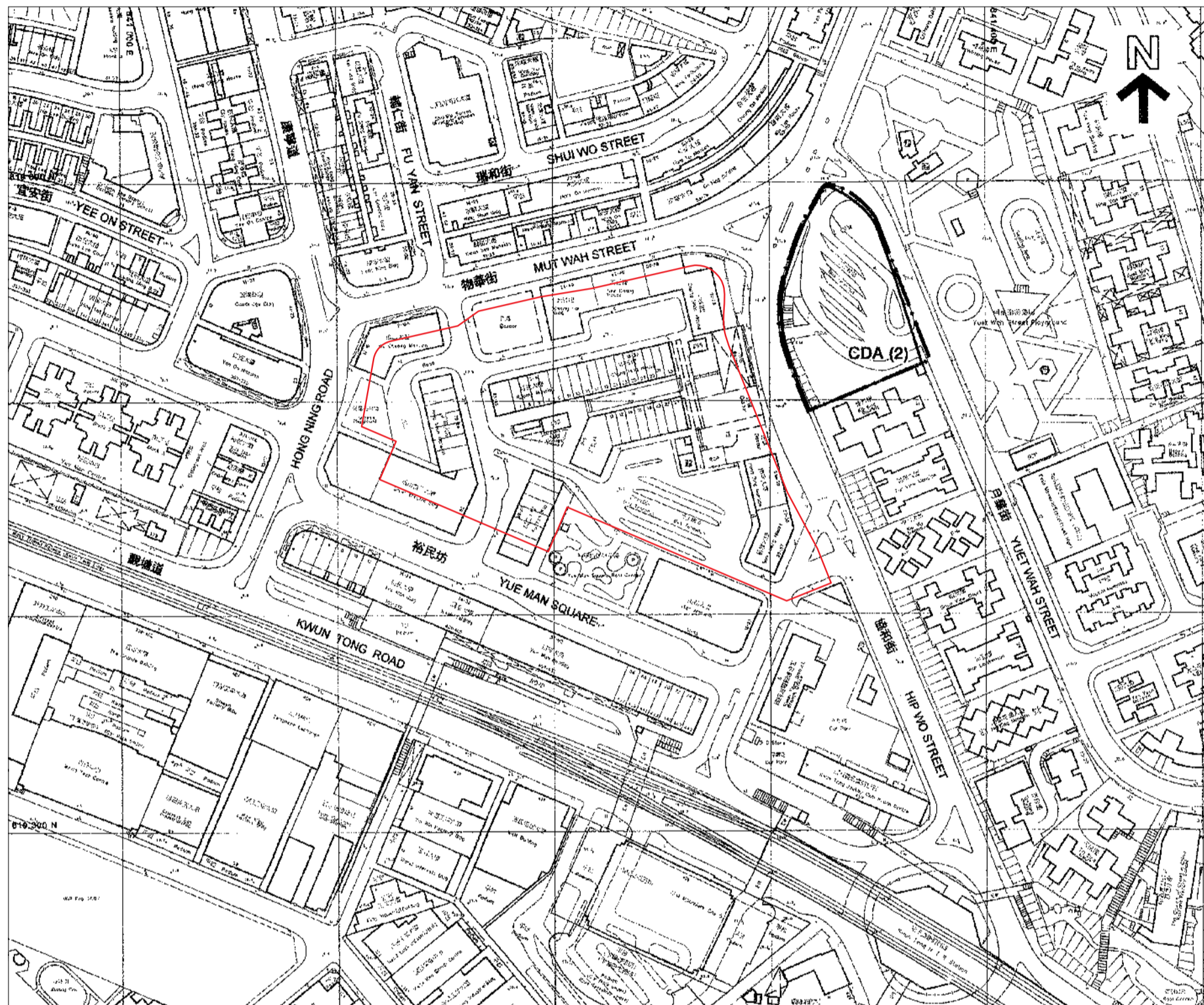

 Boundary of the Development  
 發展項目的界線

0M/米  
 Scale: 比例:  120M/米

## Notation 圖例

Boundary of Development Scheme  
 發展計劃範圍界線 

Comprehensive Development (2)  
 綜合發展區(2) 

## Remarks:

1. The Vendor advises prospective purchasers to conduct an on-site visit for a better understanding of the Development, its surrounding environment and the public facilities nearby.

## 備註:

1. 賣方建議準買家到發展項目作實地考察，以對發展項目、其周邊地區環境及附近的公共設施有較佳了解。