

# LAYOUT PLAN OF THE DEVELOPMENT

## 發展項目的布局圖

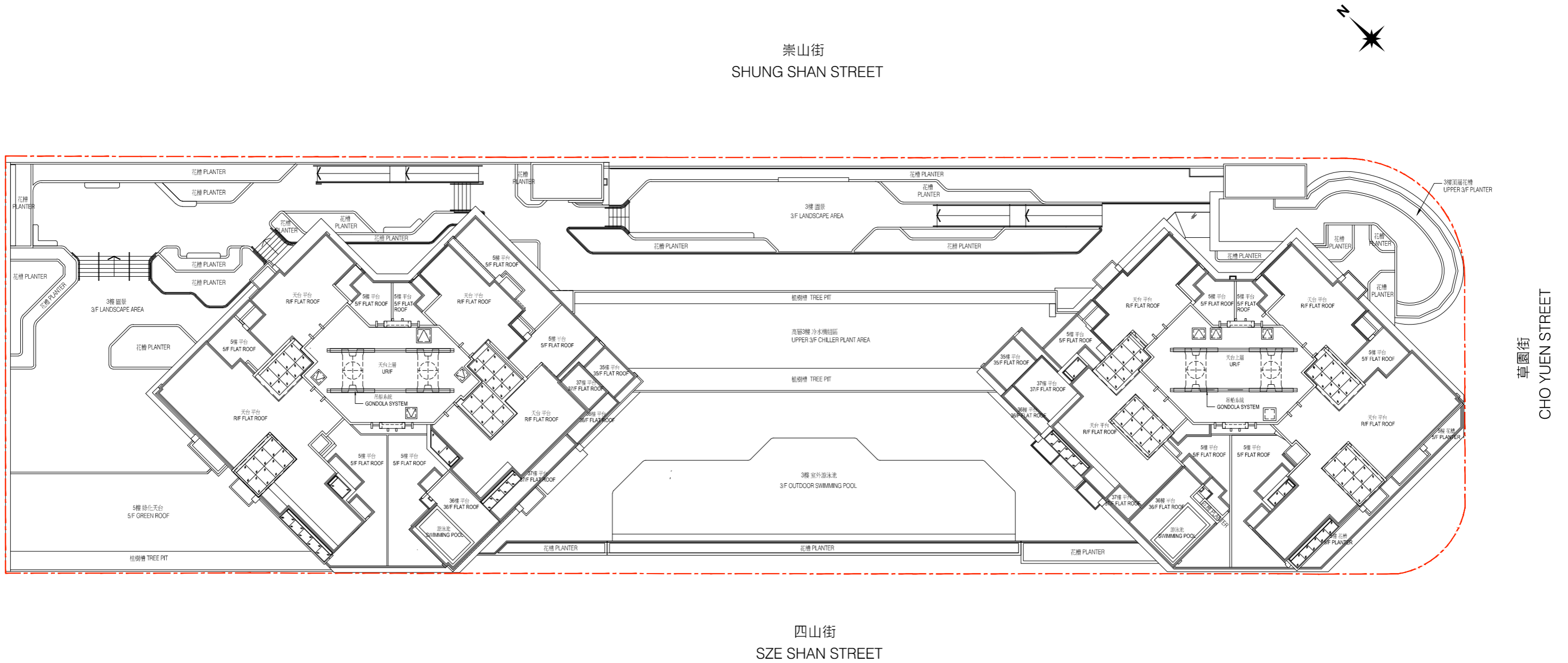

Boundary of the Development 發展項目的邊界

SCALE(比例): 0 4 8m(米)

The estimated date of completion of the building and facilities, as provided by the Authorized Person for the Development is 31 October 2020.

由發展項目的認可人士提供的建築物及設施的預計落成日期為2020年10月31日。