

LAYOUT PLAN OF THE DEVELOPMENT

發展項目的布局圖

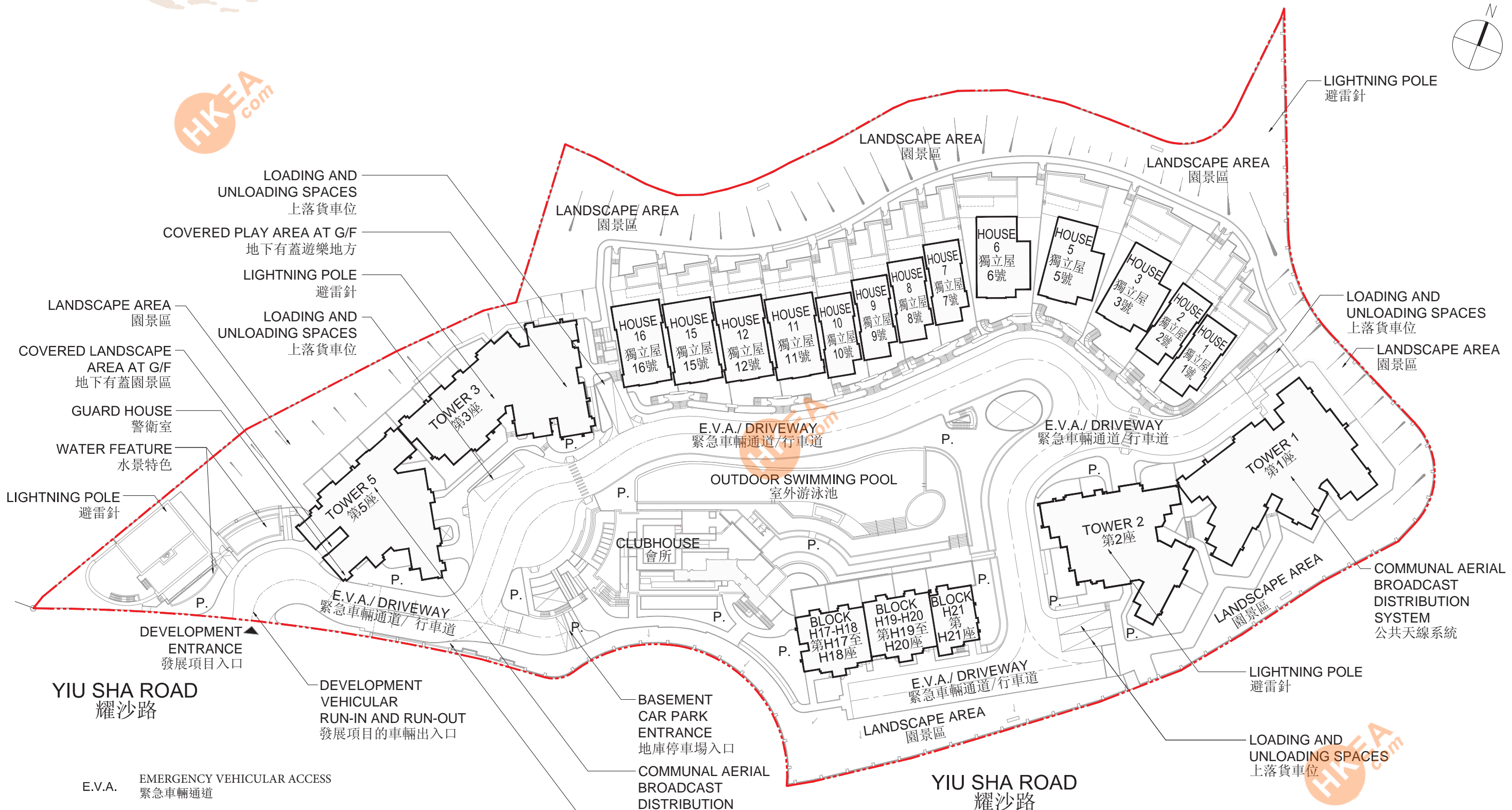

YIU SHA ROAD
耀沙路

YIU SHA ROAD
耀沙路

E.V.A. EMERGENCY VEHICULAR ACCESS
緊急車輛通道

P. PLANTER
花槽

--- BOUNDARY OF THE DEVELOPMENT
發展項目的界線

SCALE 0M/米 50M/米
比例尺：

BASEMENT CAR PARK ENTRANCE
地庫停車場入口

COMMUNAL AERIAL BROADCAST DISTRIBUTION SYSTEM
公共天線系統

LANDSCAPE AREA
園景區

The estimated date of completion of the buildings and facilities, as provided by the authorized person for the Development is 30 June 2020.
由發展項目的認可人士提供的建築物及設施的預計落成日期為2020年6月30日。