

7 LOCATION PLAN OF THE DEVELOPMENT 發展項目的所在位置圖

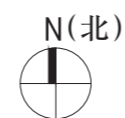
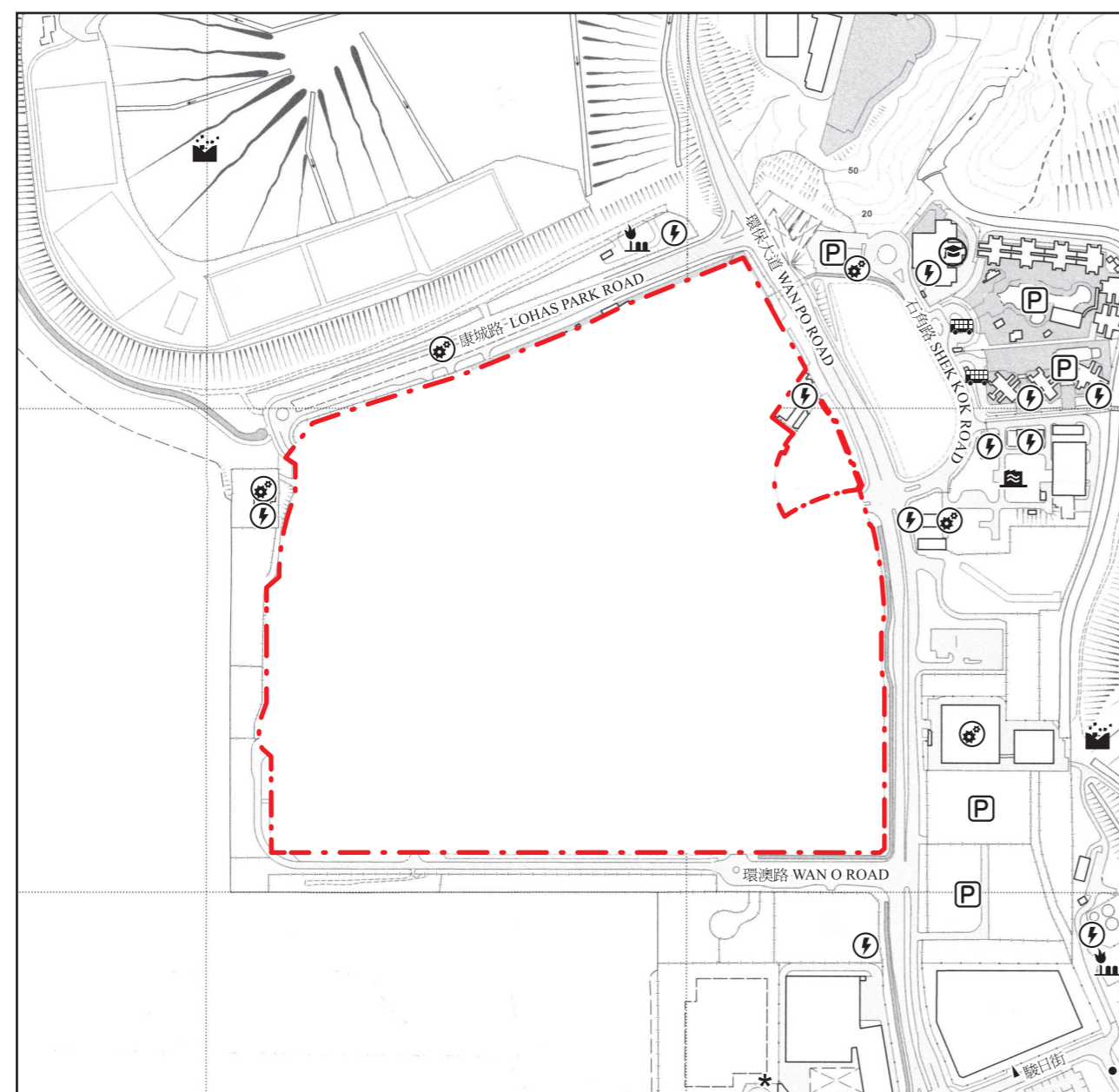

The Location Plan is made with reference to the Survey Sheet (Series HP5C) Sheet No. 12-SW-A dated 18th March 2019 from Survey and Mapping Office of the Lands Department with adjustments where necessary.

此發展項目的所在位置圖是參考於2019年3月18日出版之地政總署測繪處之測繪圖(組別編號HP5C)，圖幅編號12-SW-A編製，有需要處經修正處理。

NOTATION 圖例

Power Plant (including Electricity Sub-stations) 發電廠 (包括電力分站)	Sewage Treatment Works and Facilities 污水處理廠及設施
Public Carpark (including Lorry Park) 公眾停車場 (包括貨車停泊處)	Landfills (including Ex-landfills) 堆填區 (包括已停用的堆填區)
Public Transport Terminal (including Rail Station) 公共交通總站 (包括鐵路車站)	Landfill Gas Flaring Plant 堆填區氣體燃燒廠
Public Utility Installation 公用事業設施裝置	School (including Kindergarten) 學校 (包括幼稚園)

The Government of the Hong Kong SAR has the copyright of the above plan. The maps reproduced with permission of the Director of Lands. © The Government of Hong Kong SAR. Licence No. 67/2019.

地圖版權屬香港特區政府，經地政總署准許複印，版權特許編號67/2019.

Notes:

1. The vendor advises prospective purchasers to conduct an on-site visit for a better understanding of the development, its surrounding environment and the public facilities nearby.
2. The location plan may show more than the area required under the Residential Properties (First-hand Sales) Ordinance due to the technical reason that the boundary of the Development is irregular.

附註：

1. 賣方建議準買家到有關發展項目地盤作實地考察，以對該發展項目、其周邊地區環境及附近的公共設施有較佳了解。
2. 由於發展項目的邊界不規則的技術原因，此位置圖所顯示的範圍可能超過《一手住宅物業銷售條例》所規定的範圍。

Location of the Development
發展項目的位置

Scale: 0M/米 250M/米
比例

Street name(s) not shown in full in the Location Plan of the Development:

於發展項目的所在位置圖未能完全顯示之街道全名：

- Chun Sing Street 駿昇街
- ▲ Chun Yat Street 駿日街
- * Chun Cheong Street 駿昌街