

10 發展項目的住宅物業的樓面平面圖 Floor Plans of Residential Properties in the Development

第1座 Tower 1	樓層 Floor	A1	A2	A3	A5	A6	A7	B1	B2	B3	B5	B6	B7	B8	C1	C2	C3	C5	C6	C7	C8
層與層之間的高度(毫米) Floor-to-floor height (mm)	2樓至15樓 2/F - 15/F	3150																			
	16樓 16/F	2850, 2900, 3100, 3150, 3450, 3500	3150, 3200, 3450, 3500	3150	3100, 3150	3150, 3450	2850, 3150, 3200, 3450	2850, 3100, 3150	3150	3150	3150						3150	3150			
樓板厚度(毫米) Thickness of the floor slabs (mm)	2樓至16樓 2/F - 16/F	150										150, 200		150				150, 200			

因住宅物業的較高樓層的結構牆的厚度遞減，較高樓層的內部面積，一般比較低樓層的內部面積稍大。

The internal areas of the residential properties on the upper floors will generally be slightly larger than those on the lower floors because of the reducing thickness of the structural walls on the upper floors.

備註：

- 樓面平面圖之尺規所列數字為以毫米標示之建築結構尺寸。
- 每個住宅物業的層與層之間的高度指該樓層之結構地台面與上一層結構地台面之高度距離。
- 每個住宅物業的樓板的厚度不包括灰泥。
- 第1座不設4樓、13樓及14樓。

Notes:

- The dimensions in the floor plans are all structural dimensions in millimetre.
- The floor-to-floor height refers to the height between the top surface of the structural slab of a floor and the top surface of the structural slab of its immediate upper floor of each residential property.
- The thickness of the floor slabs excludes plaster of each residential property.
- 4/F, 13/F and 14/F are omitted in Tower 1.

第1座2樓至16樓平面圖
Tower 1, 2/F - 16/F Floor Plan

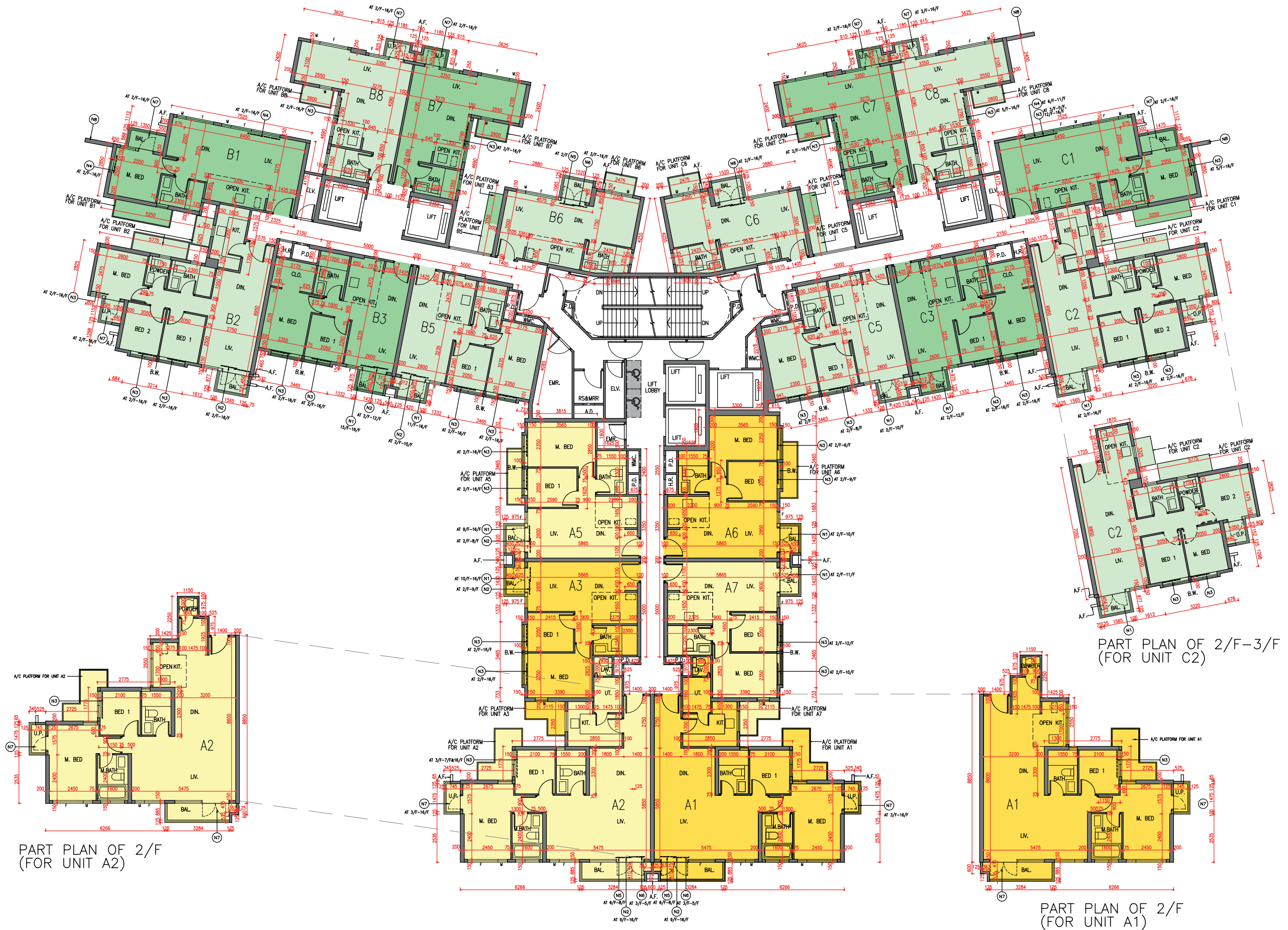

PART PLAN OF 2/F
(FOR UNIT A2)

PART PLAN OF 2/F-3/F
(FOR UNIT C2)

PART PLAN OF 2/F
(FOR UNIT A1)