

19 CROSS-SECTION PLAN OF BUILDING IN THE PHASE

期數中的建築物橫截面圖

Cross-Section Plan B-B
橫截面圖 B-B



Key Plan
索引圖

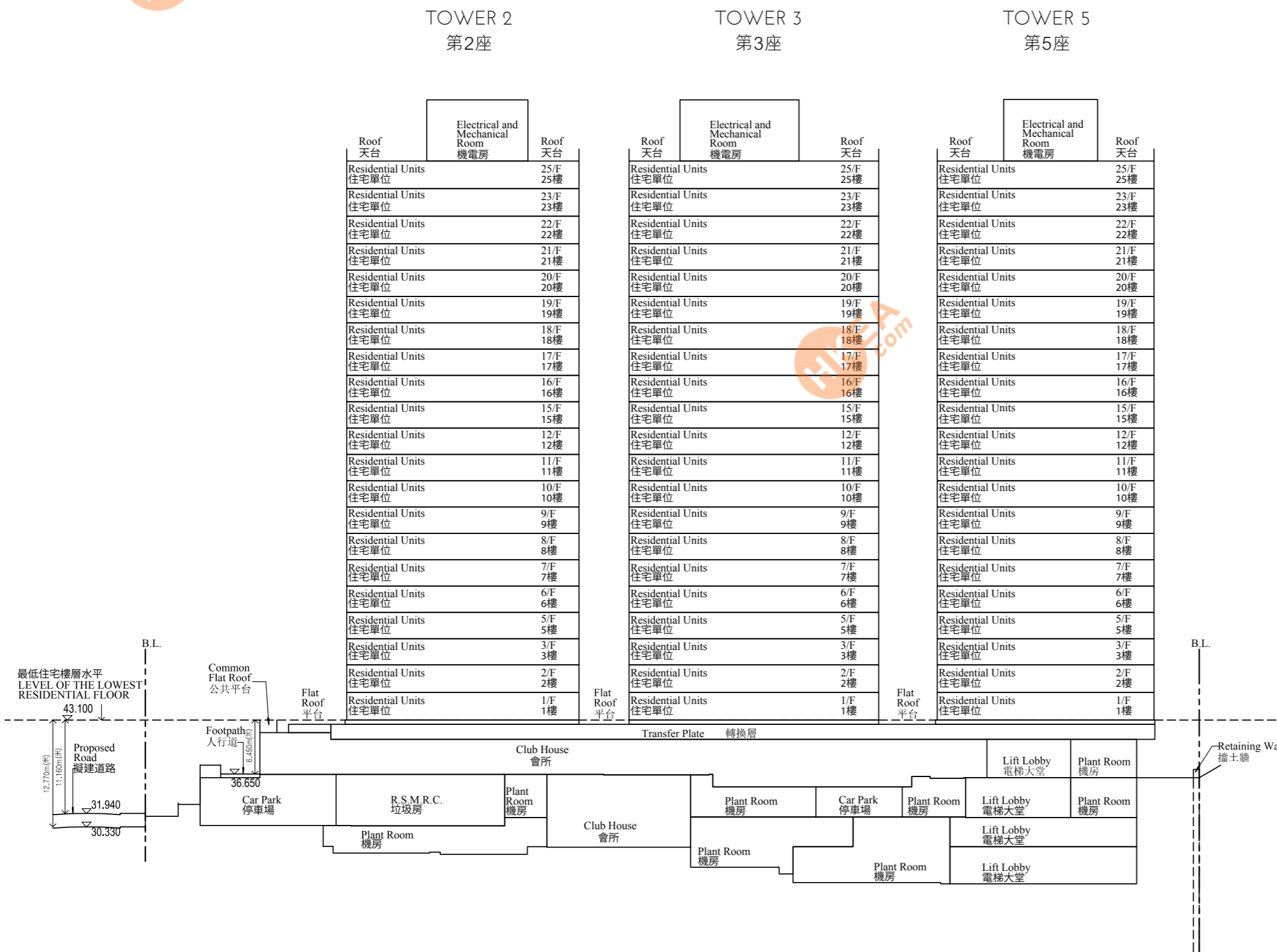
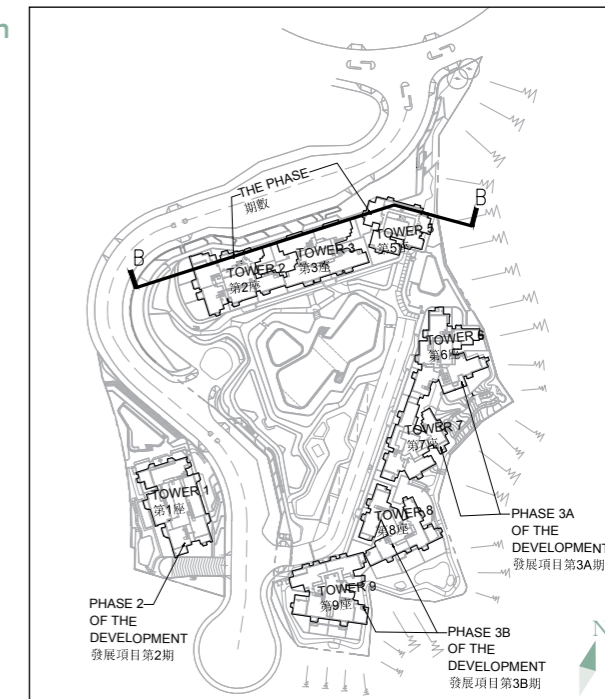

- Legend 圖例:**
- Height in metres above the Hong Kong Principal Datum (HKPD).
香港主水平基準以上高度(米)。
 - Dotted line denotes the level of the lowest residential floor of the building.
虛線為該建築物最低住宅樓層水平。
 - B.L. Boundary of the Development
發展項目的界線
 - The part of Proposed Road adjacent to the Tower 2 is 30.330 metres to 31.940 metres above the Hong Kong Principal Datum.
毗連第2座的一段擬建之道路為香港主水平基準以上30.330米至31.940米。
 - The part of the footpath adjacent to the Tower 2 is 36.650 metres above the Hong Kong Principal Datum.
毗連第2座的一段人行道為香港主水平基準以上36.650米。

19 CROSS-SECTION PLAN OF BUILDING IN THE PHASE

期數中的建築物橫截面圖

Cross-Section Plan X-X
橫截面圖 X-X

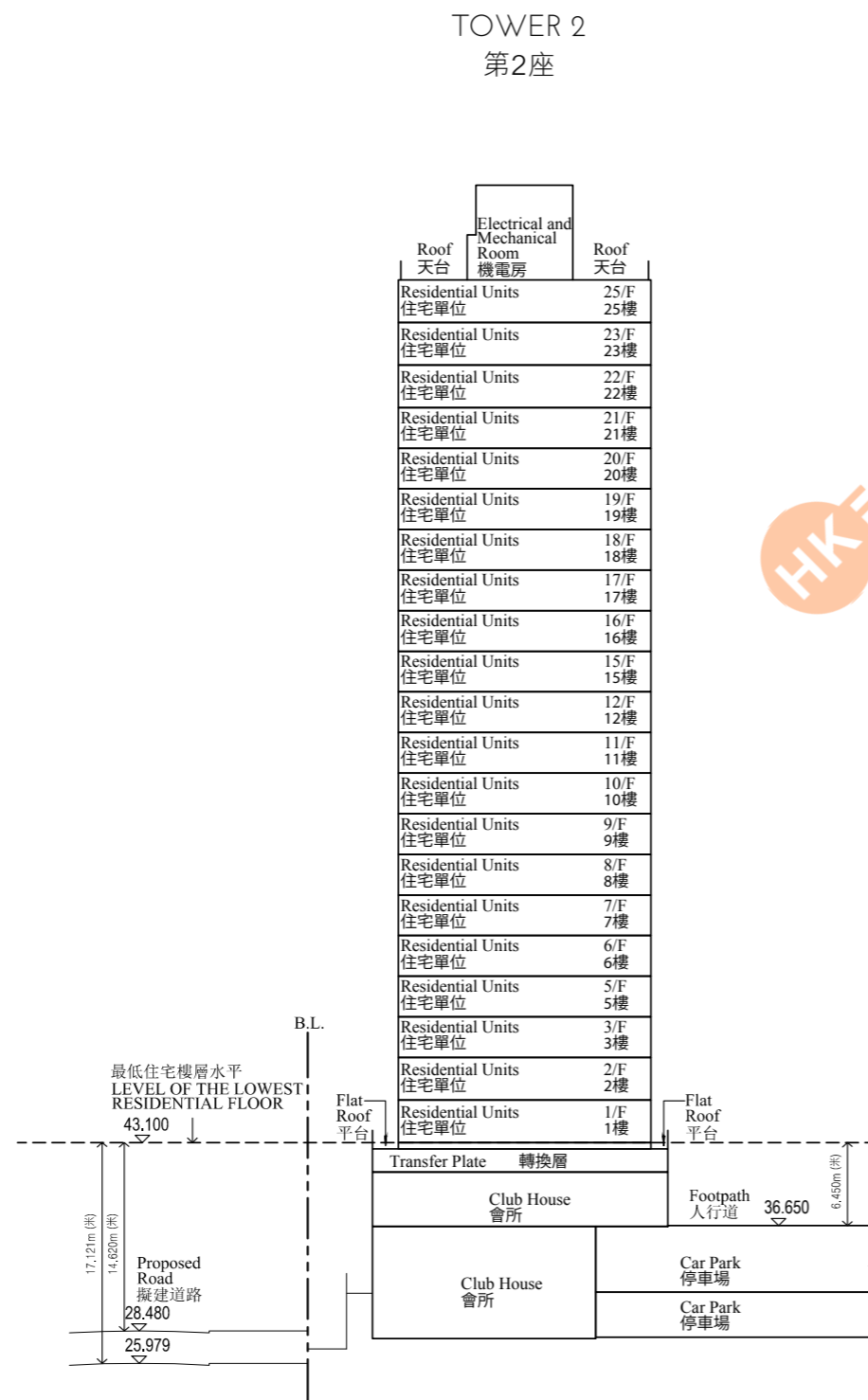

Key Plan
索引圖

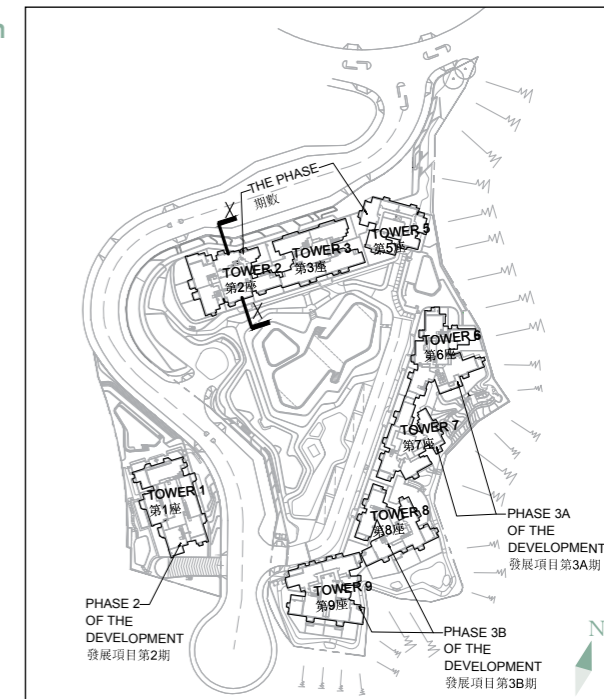

Legend 圖例：

Height in metres above the Hong Kong Principal Datum (HKPD).
香港主水平基準以上高度(米)。

Dotted line denotes the level of the lowest residential floor of the building.
虛線為該建築物最低住宅樓層水平。

B.L. Boundary of the Development
發展項目的界線

- The part of Proposed Road adjacent to the Tower 2 is 25.979 metres to 28.480 metres above the Hong Kong Principal Datum.

毗連第2座的一段擬建之道路為香港主水平基準以上25.979米至28.480米。

- The part of the footpath adjacent to the Tower 2 is 36.650 metres above the Hong Kong Principal Datum.

毗連第2座的一段人行道為香港主水平基準以上36.650米。

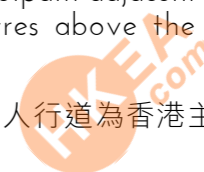

19 CROSS-SECTION PLAN OF BUILDING IN THE PHASE

期數中的建築物橫截面圖

Cross-Section Plan Y-Y
橫截面圖 Y-Y

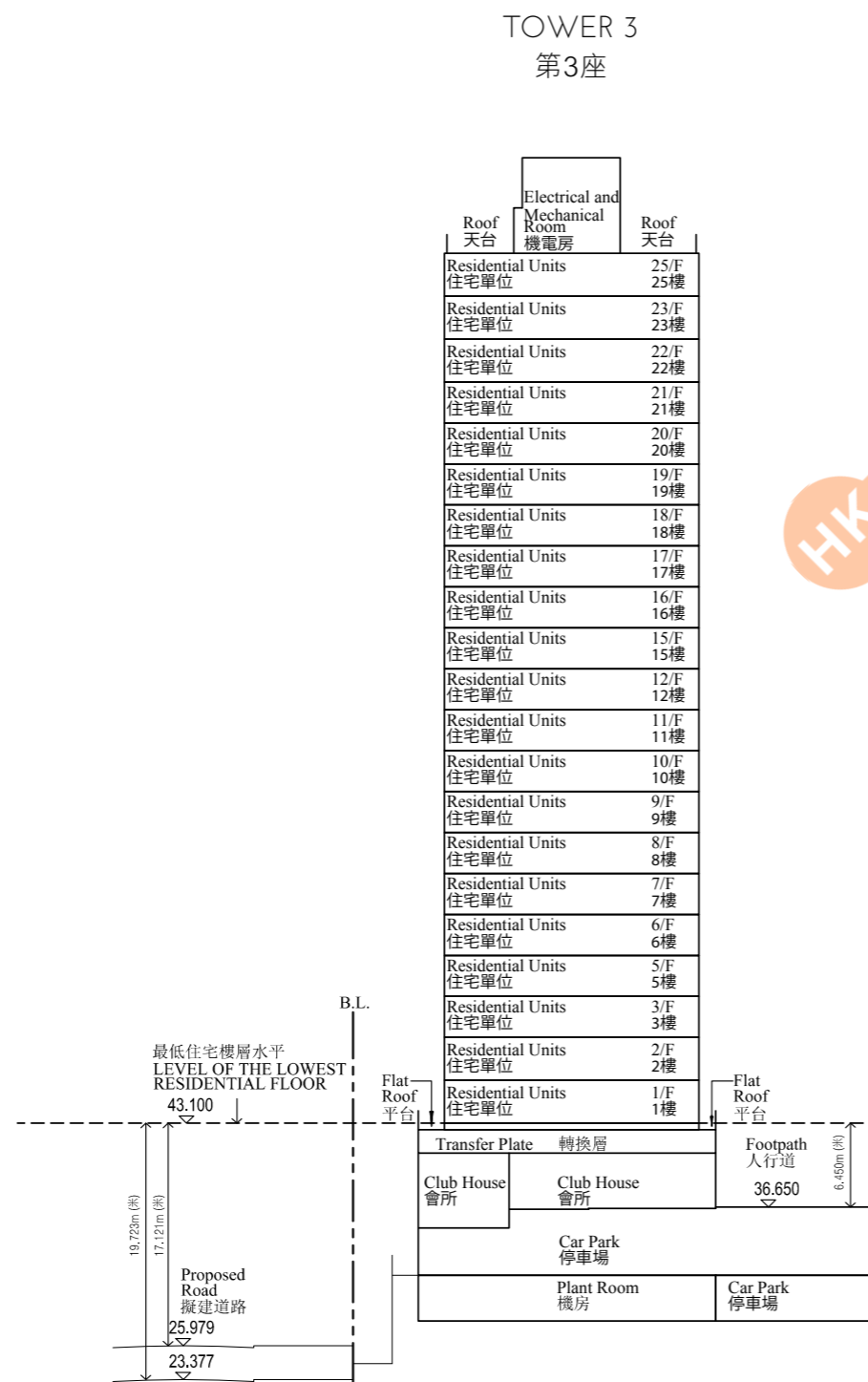

Key Plan
索引圖

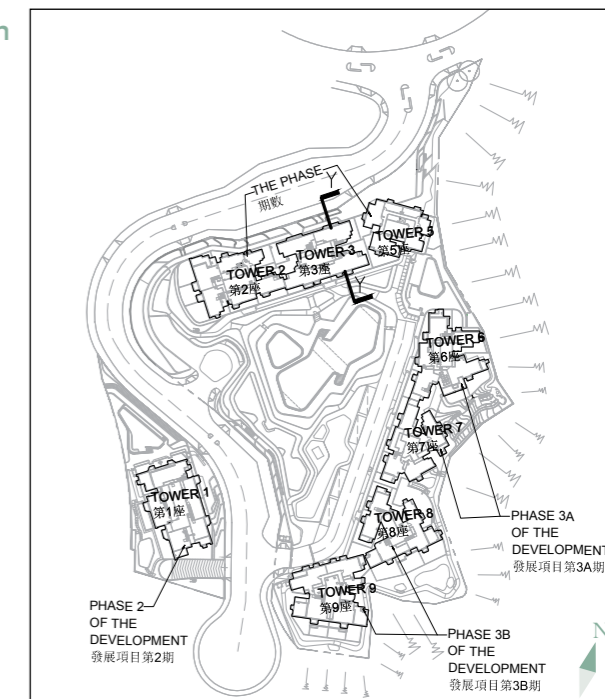

Legend 圖例：

- Height in metres above the Hong Kong Principal Datum (HKPD).
香港主水平基準以上高度(米)。
- Dotted line denotes the level of the lowest residential floor of the building.
虛線為該建築物最低住宅樓層水平。
- B.L. Boundary of the Development
發展項目的界線

- The part of Proposed Road adjacent to the Tower 3 is 23.377 metres to 25.979 metres above the Hong Kong Principal Datum.
毗連第3座的一段擬建之道路為香港主水平基準以上23.377米至25.979米。
- The part of the footpath adjacent to the Tower 3 is 36.650 metres above the Hong Kong Principal Datum.
毗連第3座的一段人行道為香港主水平基準以上36.650米。

19 CROSS-SECTION PLAN OF BUILDING IN THE PHASE

期數中的建築物橫截面圖

Cross-Section Plan Z-Z
橫截面圖 Z-Z



TOWER 5
第5座

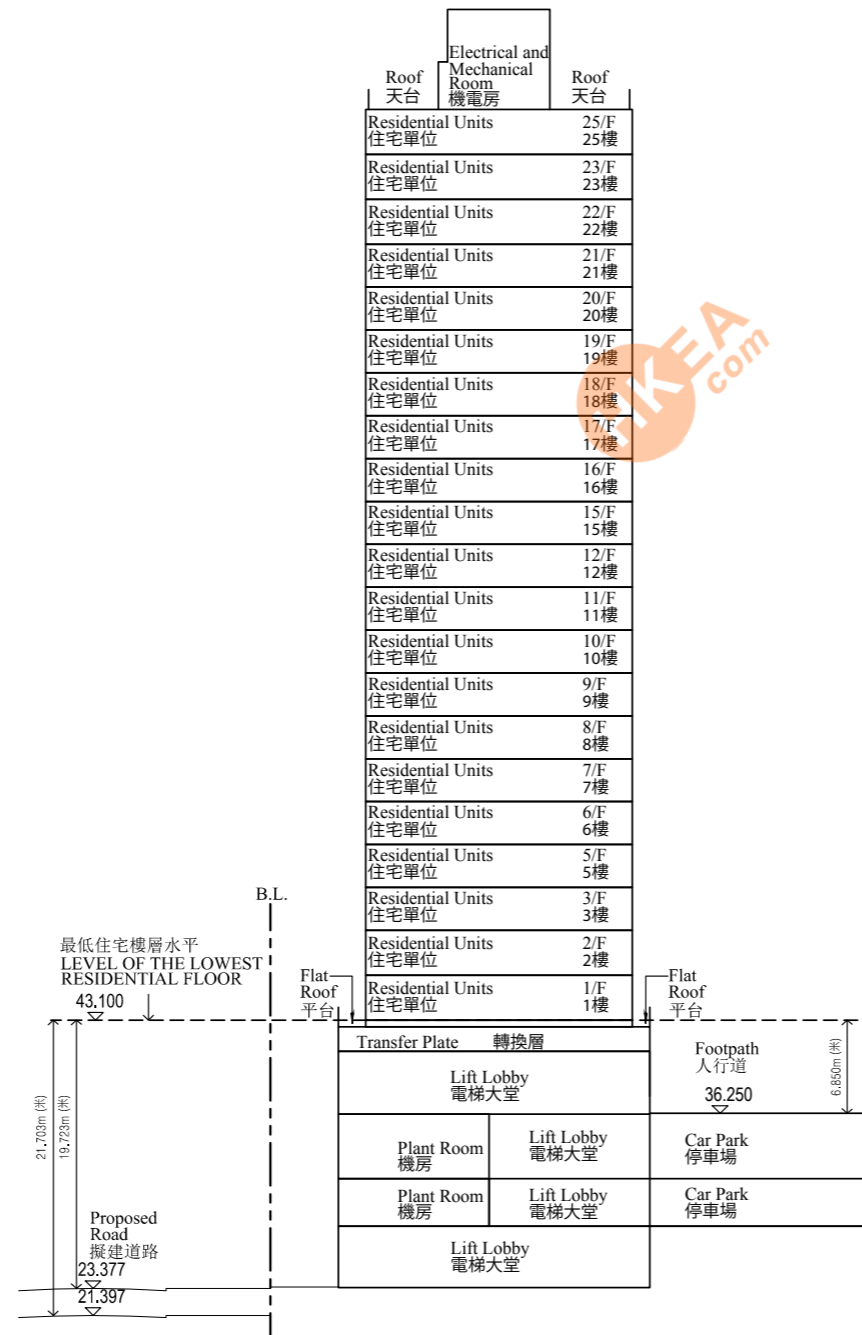

Key Plan
索引圖

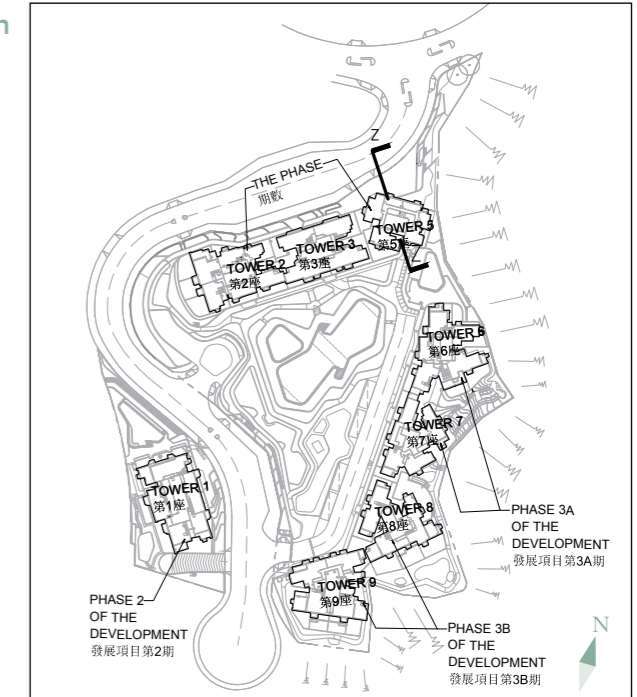

Legend 圖例 :

- Height in metres above the Hong Kong Principal Datum (HKPD).
香港主水平基準以上高度(米)。
- Dotted line denotes the level of the lowest residential floor of the building.
虛線為該建築物最低住宅樓層水平。
- B.L. Boundary of the Development
發展項目的界線

- The part of Proposed Road adjacent to the Tower 5 is 21.397 metres to 23.377 metres above the Hong Kong Principal Datum.
毗連第5座的一段擬建之道路為香港主水平基準以上21.397米至23.377米。

- The part of the footpath adjacent to the Tower 5 is 36.250 metres above the Hong Kong Principal Datum.

毗連第5座的一段人行道為香港主水平基準以上36.250米。