

10 LAYOUT PLAN OF THE DEVELOPMENT

發展項目的布局圖

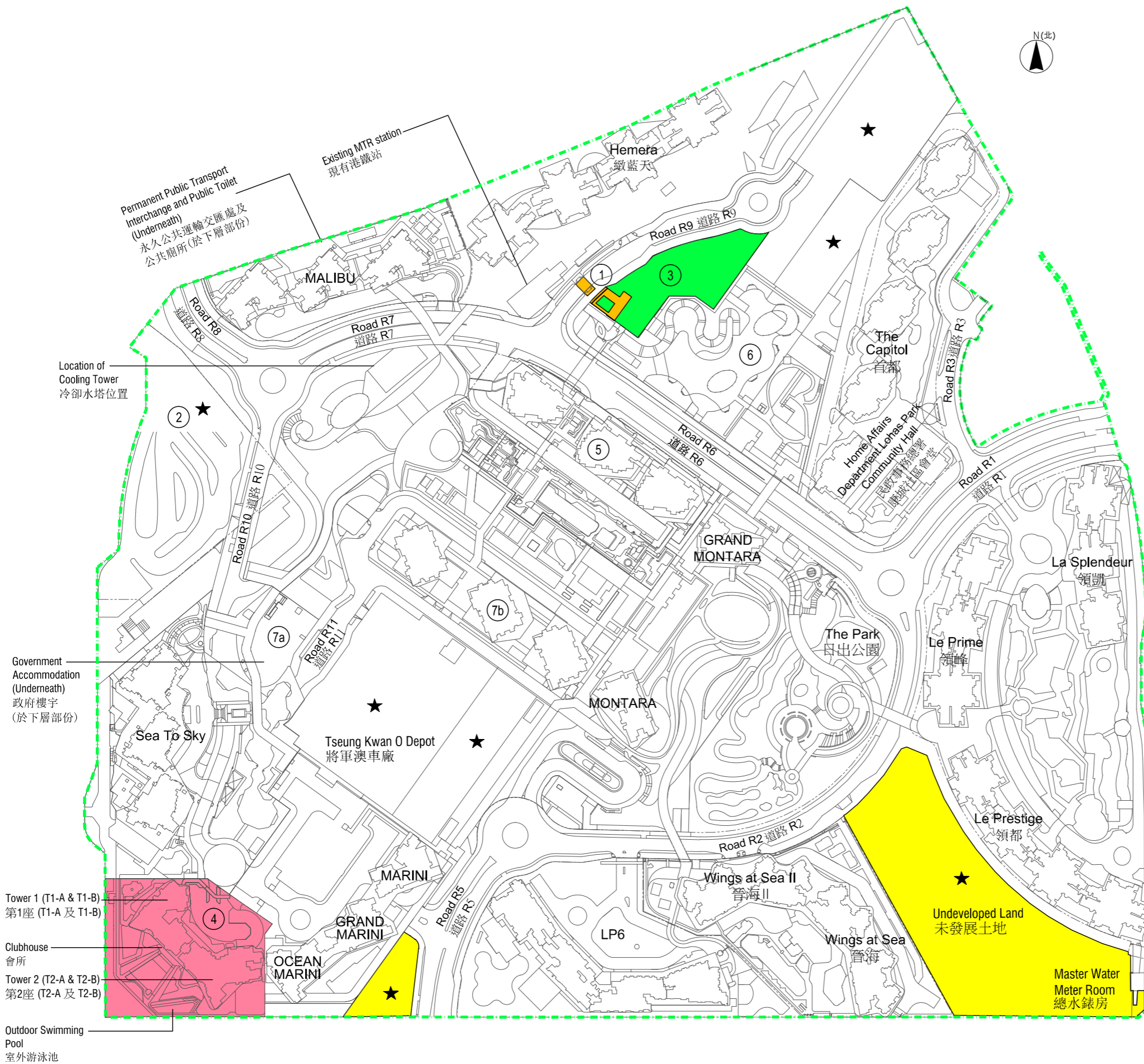

Legend 圖例

- Boundary of the Development
本發展項目邊界
- Temporary Pedestrian Walkway (Coloured Orange)
臨時行人通道 (橙色)
- Temporary Open Space (Coloured Green)
臨時休憩用地 (綠色)
- Undeveloped Land (Coloured Yellow)
未發展土地 (黃色)
- The Phase (Coloured pink)
期數 (粉紅色)

Remark: There may be future changes to the above buildings and facilities in the Development subject to the final approval by the relevant Government authorities.

備註：發展項目內的建築物及設施將來可能會有所變化，並以政府有關部門的批核為準。

Scale 比例：



10 LAYOUT PLAN OF THE DEVELOPMENT

發展項目的布局圖

1. Temporary Pedestrian Walkways (coloured orange on the plan) are existing facilities and their future uses are subject to change. The relevant facilities are also subject to removal.
臨時行人通道（圖中橙色部分）為現有設施，其未來用途或將有所改變。有關設施有可能被移除。
2. The Temporary Structure will be removed.
臨時構築物將會被移除。
3. Temporary Open Space (coloured green on the plan) is an existing facility and its future use is subject to change. The relevant facilities are also subject to removal.
臨時休憩用地（圖中綠色部分）為現有設施，其未來用途或將有所改變。有關設施有可能被移除。
4. The estimated date of completion of the Phase (coloured pink on the plan) is 30th April 2022 as provided by the authorised person for the Phase.
期數的認可人士提供期數（圖中粉紅色部分）的預計落成日期為2022年4月30日。
5. The estimated date of completion of Site C2 is 30 June 2025 as provided by the authorized person for the said development.
地盤C2的發展項目的認可人士提供該項目的預計落成日期為2025年6月30日。
6. The estimated date of completion of Site M (part) is 30 September 2022 as provided by the authorised person for the said development.
地盤M（部分）的認可人士提供該項目的預計落成日期為2022年9月30日。
- 7a. The estimated date of completion of the Government Accommodation located in Site D is 30 June 2022 as provided by the authorized person of the said developments.
位於地盤D的政府樓宇的認可人士提供該等項目的預計落成日期為2022年6月30日。
- 7b. The estimated date of completion of Site D is 31 March 2026 as provided by the authorized person for the said development.
地盤D的發展項目的認可人士提供該項目的預計落成日期為2026年3月31日。
- ★ For Undeveloped Land (coloured yellow on the plan) and undeveloped sites, the intended uses include residential, open space and Government, Institution or Community uses.
未發展土地（圖中黃色部分）及未發展地盤之規劃用途將包括住宅、休憩用地及政府、機構或社區設施。