

11 FLOOR PLANS OF RESIDENTIAL PROPERTIES IN THE DEVELOPMENT

發展項目的住宅物業的樓面平面圖

9/F to 13/F, 15/F to 23/F, 25/F Floor Plan
 9樓至13樓、15樓至23樓、25樓樓面平面圖

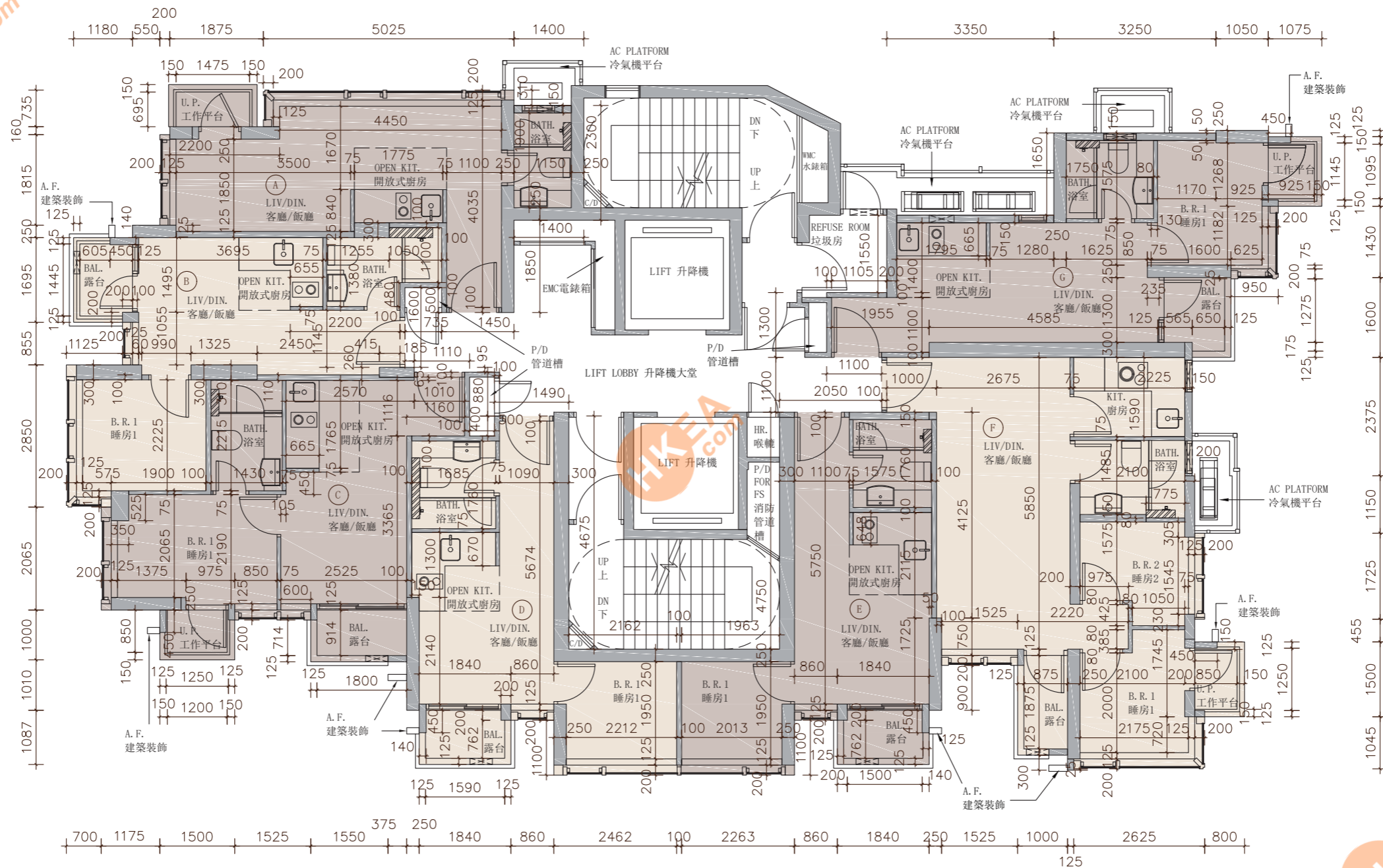

Scale 0 2 4M(米)
 比例

11 FLOOR PLANS OF RESIDENTIAL PROPERTIES IN THE DEVELOPMENT

發展項目的住宅物業的樓面平面圖

Each Residential Property 每個住宅物業	Floor 樓層	Flat單位						
		A	B	C	D	E	F	G
The thickness of the floor slabs (excluding plaster) of each residential property (mm) 每個住宅物業的樓板(不包括灰泥)的厚度(毫米)	9/F - 13/F & 15/F - 23/F 9樓至13樓及 15樓至23樓	150	150	150	150	150	150	150
The floor-to-floor height ⁽¹⁾ of each residential property (mm) 每個住宅物業的層與層之間的高度 ⁽¹⁾ (毫米)		3390, 3140, 3090, 2890	3390, 3140, 2790	3390, 3090, 2740	3390, 3140, 2790	3390, 3140, 2840	3390, 3140, 2840	3390, 3140, 2890, 2820
The thickness of the floor slabs (excluding plaster) of each residential property (mm) 每個住宅物業的樓板(不包括灰泥)的厚度(毫米)	25/F 25樓	150	150	150	150	150	150	150
The floor-to-floor height ⁽¹⁾ of each residential property (mm) 每個住宅物業的層與層之間的高度 ⁽¹⁾ (毫米)		3390, 3090, 3040, 2840	3390, 3040	3390, 3040, 2890	3390, 3040, 2890	3390, 2940	3390, 3240, 3040, 2940, 2740, 2690	3390, 3240, 2890

⁽¹⁾ Refers to the height between the top surface of the structural slab of the floor and the top surface of the structural slab of its immediate upper floor

⁽¹⁾ 指該樓層之石屎地台面與上一層石屎地台面之高度距離

Notes:

- The dimensions on the floor plans are all structural dimensions in millimetre.
- The internal areas of the residential properties on the upper floors will generally be slightly larger than those on the lower floors because of the reducing thickness of the structural walls on the upper floors.

備註：

- 樓面平面圖所列之數字為以毫米標示之建築結構尺寸。
- 因住宅物業的較高樓層的結構牆的厚度遞減，較高樓層的內部面積，一般比較低樓層的內部面積稍大。