

- Residential Car Parking Space  
住宅車輛停車位
- Residential Accessible Parking Space\*  
住宅暢通易達停車位\*
- Residential Visitors' Parking Space  
住宅訪客停車位
- Residential Motor Cycle Parking Space  
住宅電單車停車位
- Commercial Car Parking Space  
商業車輛停車位
- Commercial Motor Cycle Parking Space  
商業電單車停車位
- Kindergarten Parking Space  
幼稚園停車位
- Site Boundary of the Development  
發展項目邊界

Note\*:

- (1) Designated out of Residential Car Parking Space, Residential Visitors' Parking Space and Commercial Car Parking Space.
- (2) Under Special Condition 48(c)(ii) of Land Grant, Residential Accessible Parking Spaces shall be used for parking of motor vehicles by disabled persons belonging to the residents, their bona fide guests, visitors and invitees.

備註\*:

- (1) 由住宅車輛停車位、住宅訪客停車位及商業車輛停車位劃出。
- (2) 根據批地文件特別批地條款第48(c)(ii)條，住宅暢通易達停車位為供傷殘人士停泊屬於住戶及彼等真正賓客、訪客或獲邀請人士之車輛。



BASEMENT  
地庫

Scale 0 25M/米  
比例

- Residential Bicycle Parking Space  
住宅單車停車位
- Commercial Loading and Unloading Bay  
商業上落貨停車位
- Kindergarten Taxi & Private Car Lay-by  
幼稚園的士及私家車停車處
- Kindergarten School Bus Lay-by  
幼稚園學校巴士停車處
- Refuse Collection Vehicle Parking Space  
垃圾收集車停車位
- Site Boundary of the Development  
發展項目邊界

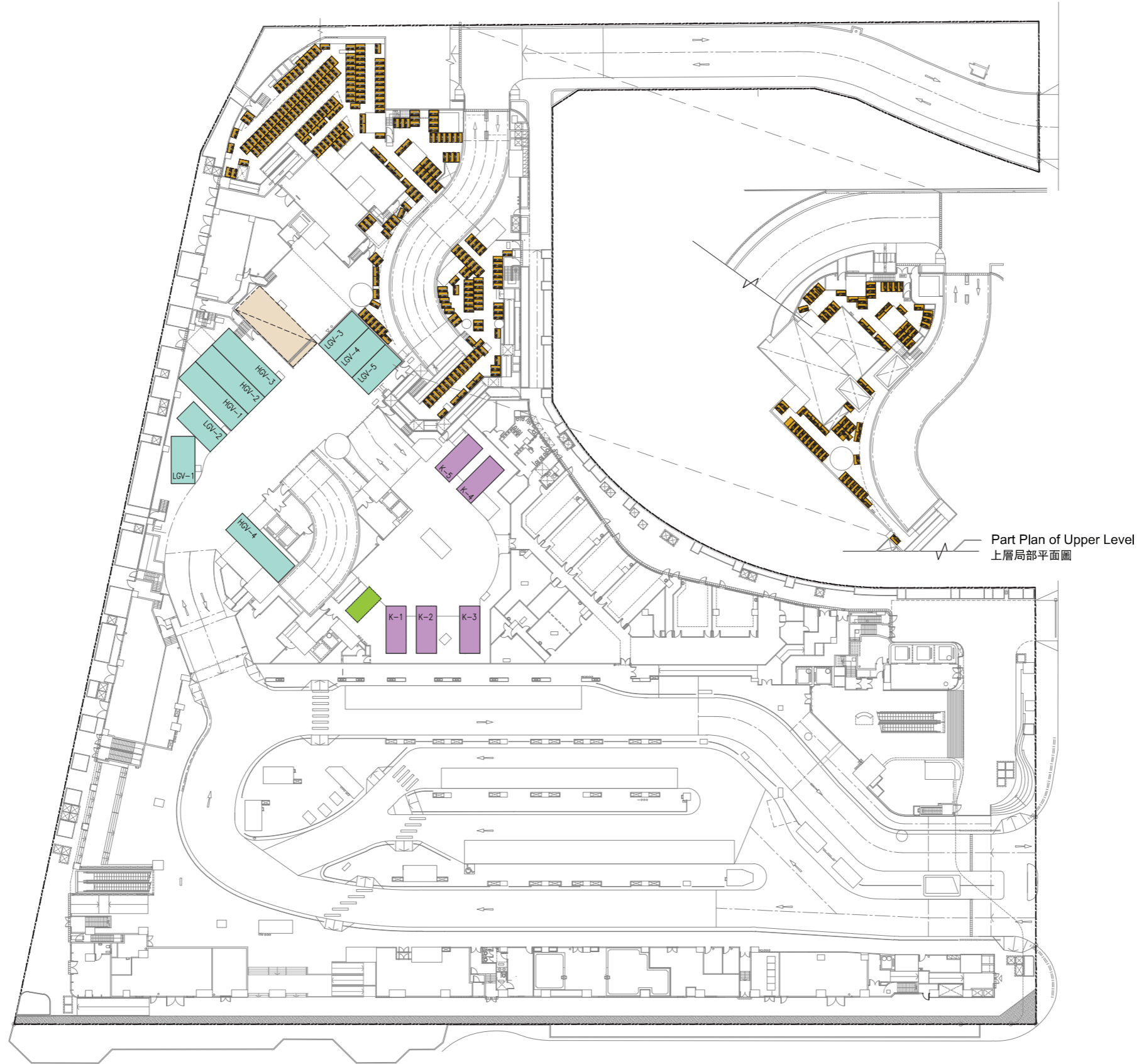

Part Plan of Upper Level  
上層局部平面圖

GROUND FLOOR  
地下

Scale 0 25M/米  
比例

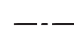

PART GROUND OF GROUND FLOOR  
地下局部平面圖

-  Residential Bicycle Parking Space  
住宅單車停車位
-  Site Boundary of the Development  
發展項目邊界

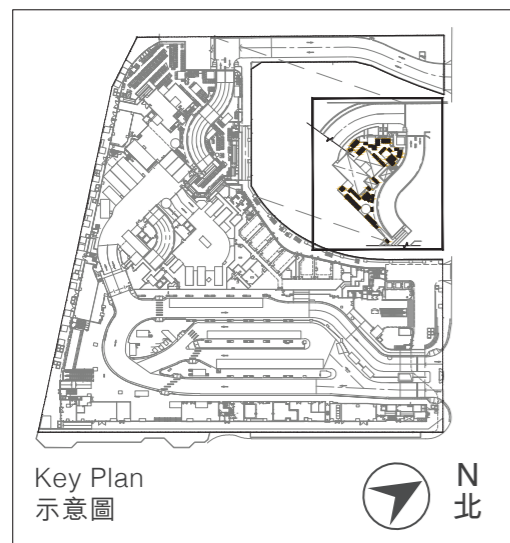

PART PLAN OF UPPER GROUND LEVEL  
地下上層平面圖

Scale 0 10M/米  
比例 

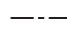
-  Residential Loading and Unloading Bay  
住宅上落貨停車位
-  Site Boundary of the Development  
發展項目邊界

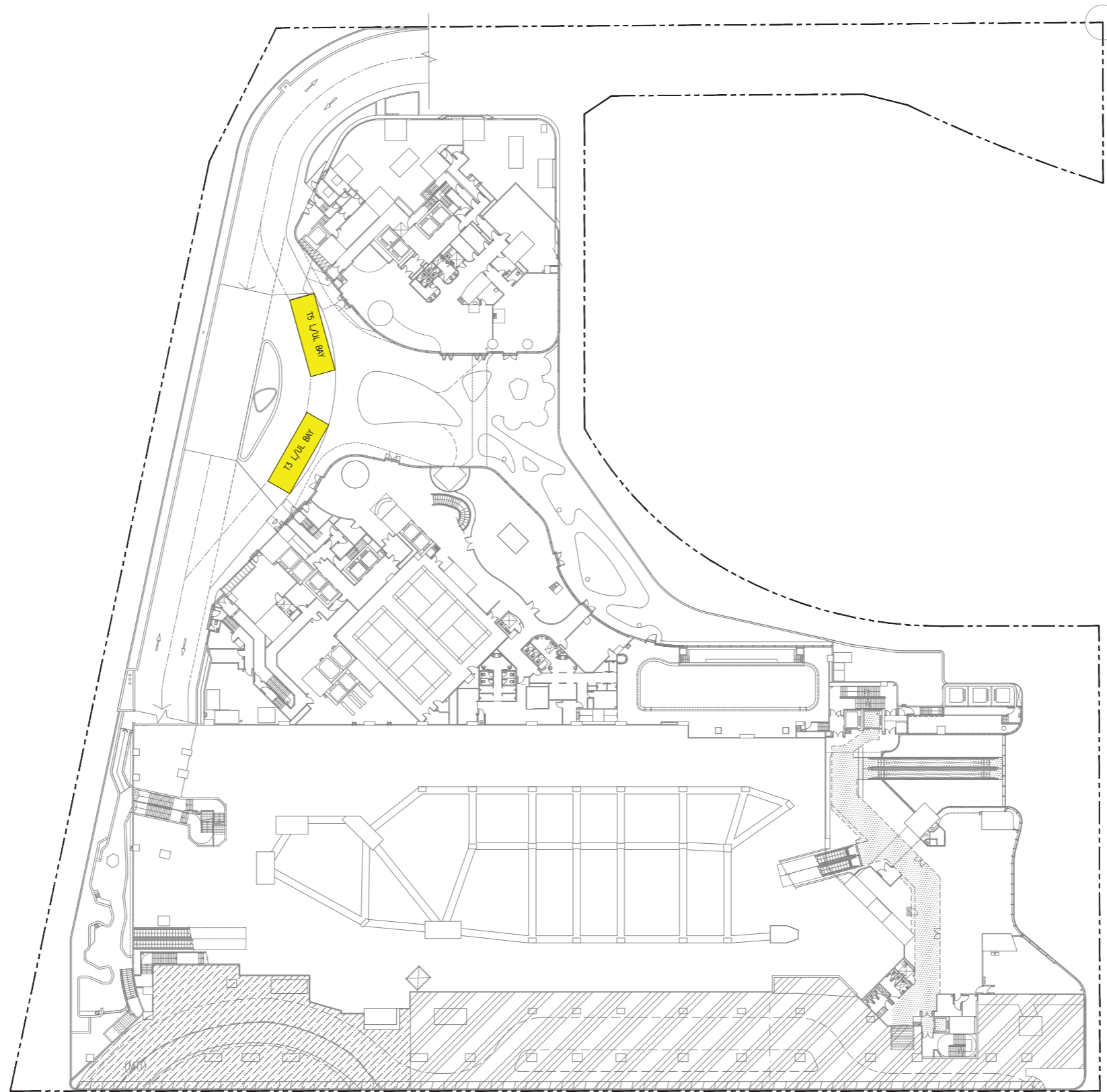

1ST FLOOR  
一樓

Scale 0 25M/米  
比例 

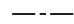
-  Residential Loading and Unloading Bay  
住宅上落貨停車位
-  Site Boundary of the Development  
發展項目邊界

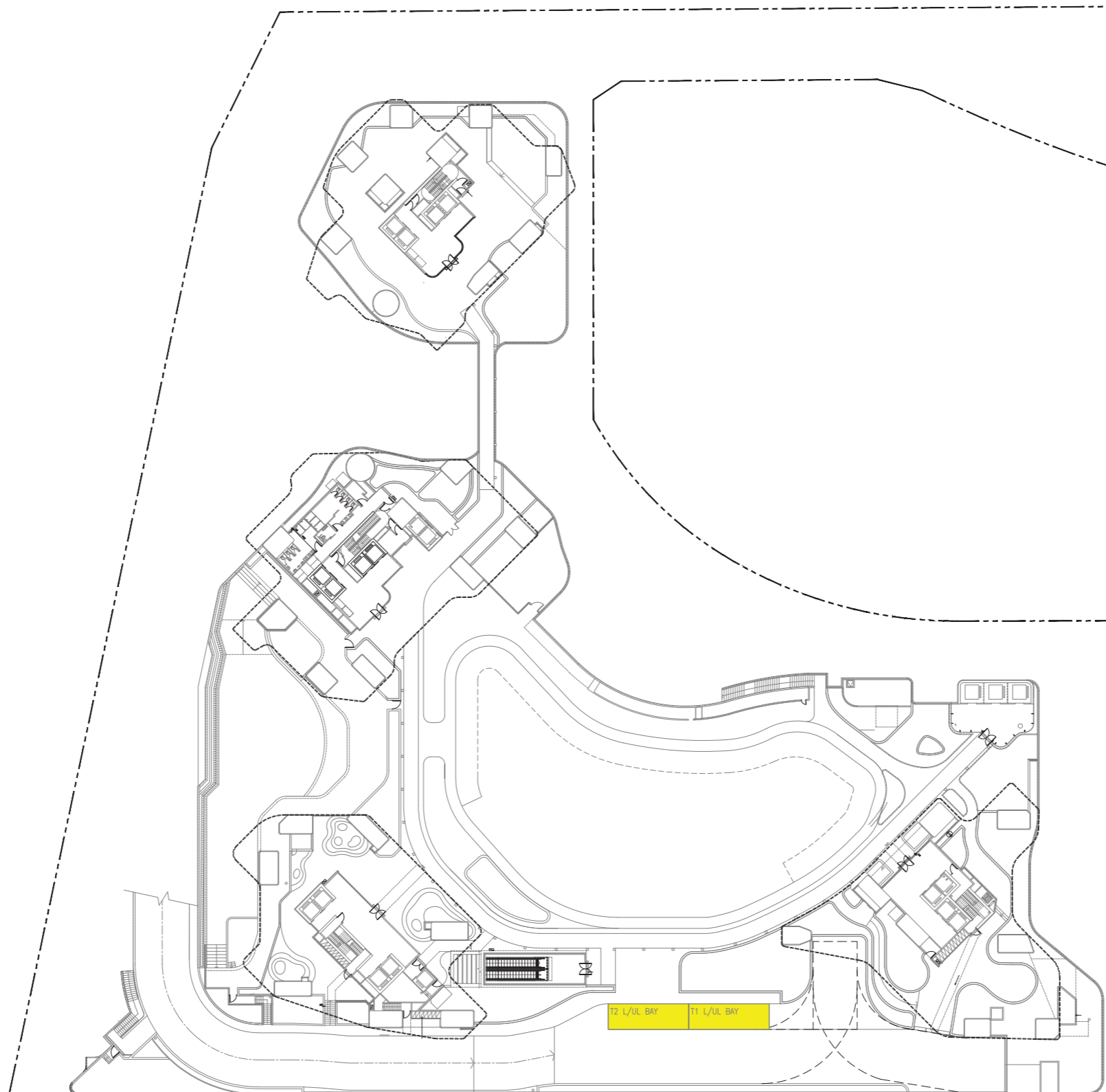

P FLOOR  
基座平台

Scale 0 25M/米  
比例 

Floor 樓層	Category of parking space 停車位類別		Number 數目	Dimensions (L x W) (m) 尺寸 (長X闊) (米)	Area of each parking space (sq.m) 每個停車位面積 (平方米)
B/F 地庫	Residential 住宅	Car Parking Space 車輛停車位	196	5 x 2.5	12.5
		Visitors' Parking Space 訪客停車位	18	5 x 2.5	12.5
		Accessible Parking Space* 暢通易達停車位*	4	5 x 3.5	17.5
		Motor Cycle Parking Space 電單車停車位	20	2.5 x 1	2.5
G/F 地下		Bicycle Parking Space 單車停車位	334	1.4 x 0.8	1.12
1/F 1樓		Loading and Unloading Bay 上落貨車位	2	11 x 3.5	38.5
P/F 基座平台		Loading and Unloading Bay 上落貨車位	2	11 x 3.5	38.5
B/F 地庫	Commercial 商業	Car Parking Space 車輛停車位	35	5 x 2.5	12.5
		Motor Cycle Parking Space 電單車停車位	4	2.5 x 1	2.5
G/F 地下		Loading and Unloading Bay 上落貨車位	4	11 x 3.5	38.5
			5	7 x 3.5	24.5
B/F 地庫		Parking Space 停車位	1	5 x 2.5	12.5
G/F 地下	Kindergarten 幼稚園	Taxi & Private Car Lay-by 的士及私家車停車處	1	5 x 2.5	12.5
		School Bus Lay-by 學校巴士停車處	5	7 x 3	21
		Refuse Collection Vehicle Parking Space 垃圾收集車停車位	1	12 x 5	60

Note\*:

- (1) Designated out of Residential Car Parking Space, Residential Visitors' Parking Space and Commercial Car Parking Space.  
(2) Under Special Condition 48(c)(ii) of Land Grant, Residential Accessible Parking Spaces shall be used for parking of motor vehicles by disabled persons belonging to the residents, their bona fide guests, visitors and invitees.

備註\*:

- (1) 由住宅車輛停車位、住宅訪客停車位及商業車輛停車位劃出。  
(2) 根據批地文件特別批地條款第48(c)(ii)條，住宅暢通易達停車位為供傷殘人士停泊屬於住戶及彼等真正賓客、訪客或獲邀請人士的車輛。