

FLOOR PLANS OF RESIDENTIAL PROPERTIES IN THE PHASE

期數的住宅物業的樓面平面圖

Block Name 大廈名稱	Floor 樓層	Flat 單位	Floor-to-floor height of each residential property (mm) 每個住宅物業的層與層之間的高度(毫米)	The thickness of the floor slabs (excluding plaster) of each residential property (mm) 每個住宅物業的樓板(不包括灰泥)的厚度(毫米)
GREENWOOD TOWER 2 翠景閣第2座	2/F-3/F & 5/F-10/F 2樓至3樓及 5樓至10樓	A1	3150, 3050, 2850	200, 125
		A2	3150, 3050, 2900, 2850, 2775	200, 175, 125
		A3	3150, 3050, 2775	200, 125
		A5	3150, 2900, 2850	175, 125
		A6	3150, 3050, 2850	200, 175, 125
		B1	3150, 3050, 2850, 2775	200, 175, 125
		B2	3150, 2900, 2850	175, 125
		B3	3150, 2900, 2850	175, 125
		B5	3150, 3050, 2850, 2775	200, 175, 125
		B6	3150, 3050, 2850, 2775	175, 125
		B8	3150, 3050, 2900, 2850	175, 125
	11/F 11樓	A1	3325, 3075	200, 125
		A2	3325, 3075, 3025, 2950, 2825	200, 175, 125
		A3	3325, 3225, 2950	200, 125
		A5	3325, 3075, 3025	175, 125
		A6	3325, 3225, 3025	200, 175, 125
		B1	3325, 3225, 3025, 2950	200, 175, 125
		B2	3325, 3075, 3025	175, 125
		B3	3325, 3075, 3025, 2950	175, 125
		B5	3325, 3125, 3075, 3025, 2950	200, 175, 125
		B6	3325, 3225, 3075, 2950	175, 125
		B8	3325, 3225, 3075, 3025	175, 125

The internal areas of the residential properties on the upper floors will generally be slightly larger than those on the lower floors because of the reducing thickness of structural walls on the upper floors. (This does not apply to the residential properties in the Phase because the design of the Phase does not involve reducing thickness of structural walls of residential properties on the upper floors.)

因住宅物業的較高樓層的結構牆的厚度遞減，較高樓層的內部面積，一般比較低樓層的內部面積稍大。（不適用於期數內的住宅物業，因期數的設計並不牽涉住宅物業的較高樓層的結構牆的厚度遞減。）

NOTES:

1. The dimensions of the floor plans are all structural dimensions in millimeter.
2. Please refer to pages AL01-AL04 of this sales brochure for legend of the terms and abbreviations shown on the floor plan and the explanatory notes that are applicable thereto.

備註:

1. 樓面平面圖之尺規所列數字為以毫米標示之建築結構尺寸。
2. 平面圖中顯示之名詞、簡稱之圖例及其適用的附註，請參閱本售樓說明書第AL01-AL04頁。

FLOOR PLANS OF RESIDENTIAL PROPERTIES IN THE PHASE

期數的住宅物業的樓面平面圖

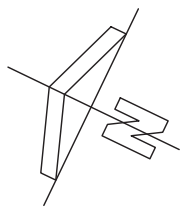
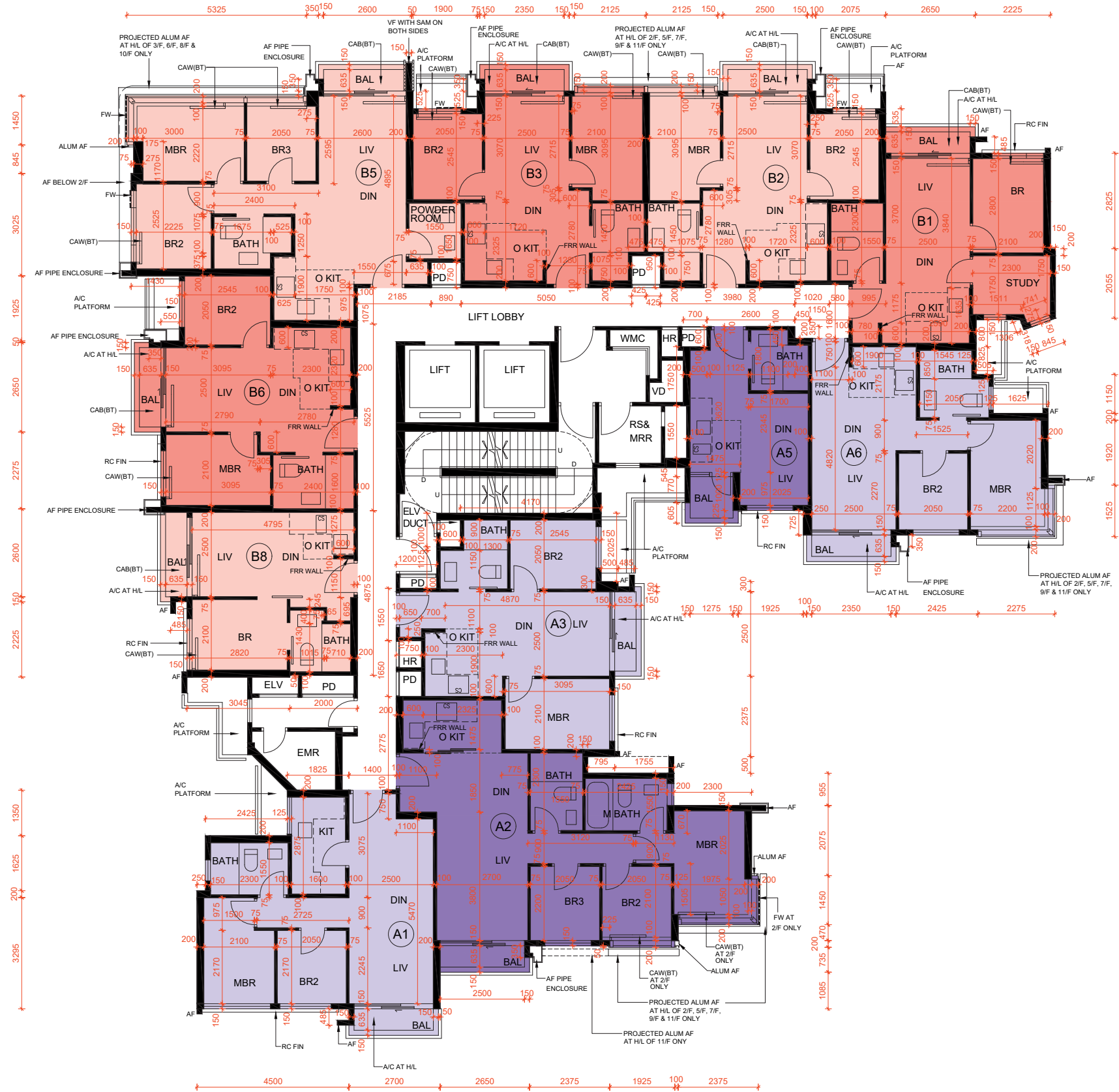

GREENWOOD TOWER 2 2/F-3/F AND 5/F-11/F FLOOR PLAN
翠景閣第2座 2樓至3樓 及 5樓至11樓平面圖

