

FLOOR PLANS OF RESIDENTIAL PROPERTIES IN THE PHASE

期數的住宅物業的樓面平面圖

Block Name 大廈名稱	Floor 樓層	Flat 單位	Floor-to-floor height of each residential property (mm) 每個住宅物業的層與層之間的高度(毫米)	The thickness of the floor slabs (excluding plaster) of each residential property (mm) 每個住宅物業的樓板(不包括灰泥)的厚度(毫米)
GREENWOOD TOWER 2 翠景閣第2座	12/F 12樓	A1	3700	200
		A3	3700	200
		A5	3700	200
		A6	3700	200
		B1	3700, 3300	200
		B2	3700	200
		B5	3700	200
		B6	3700	200
		B8	3700	200

The internal areas of the residential properties on the upper floors will generally be slightly larger than those on the lower floors because of the reducing thickness of structural walls on the upper floors. (This does not apply to the residential properties in the Phase because the design of the Phase does not involve reducing thickness of structural walls of residential properties on the upper floors.)

因住宅物業的較高樓層的結構牆的厚度遞減，較高樓層的內部面積，一般比較低樓層的內部面積稍大。（不適用於期數內的住宅物業，因期數的設計並不牽涉住宅物業的較高樓層的結構牆的厚度遞減。）

NOTES:

1. The dimensions of the floor plans are all structural dimensions in millimeter.
2. Please refer to pages AL01-AL04 of this sales brochure for legend of the terms and abbreviations shown on the floor plan and the explanatory notes that are applicable thereto.

備註:

1. 樓面平面圖之尺規所列數字為以毫米標示之建築結構尺寸。
2. 平面圖中顯示之名詞、簡稱之圖例及其適用的附註，請參閱本售樓說明書第AL01-AL04頁。

FLOOR PLANS OF RESIDENTIAL PROPERTIES IN THE PHASE

期數的住宅物業的樓面平面圖

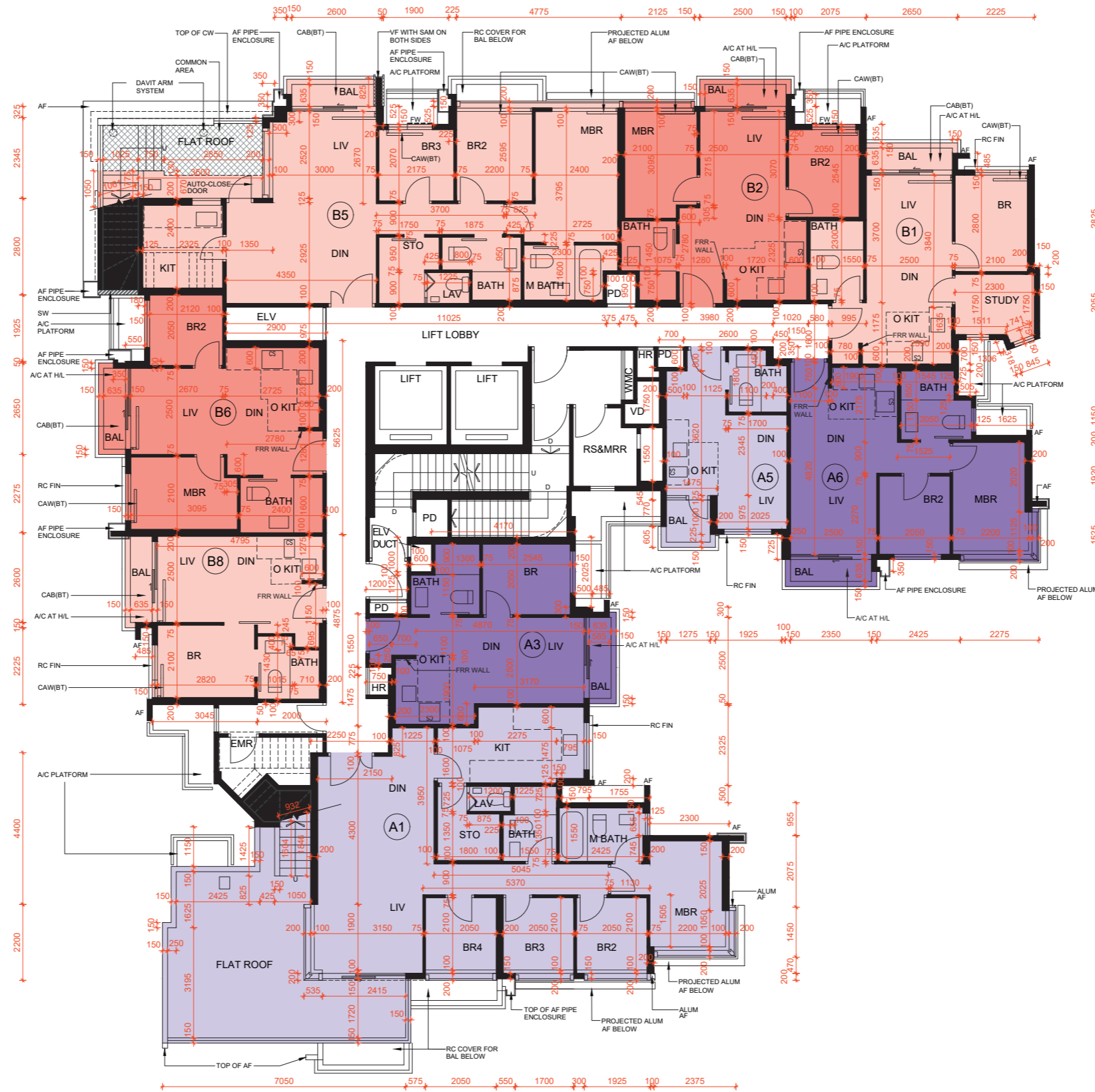

GREENWOOD TOWER 2 12/F FLOOR PLAN
翠景閣第2座 12樓平面圖

Scale 比例
 0m / 米 5m / 米

FLOOR PLANS OF RESIDENTIAL PROPERTIES IN THE PHASE

期數的住宅物業的樓面平面圖

Block Name 大廈名稱	Floor 樓層	Flat 單位	Floor-to-floor height of each residential property (mm) 每個住宅物業的層與層之間的高度(毫米)	The thickness of the floor slabs (excluding plaster) of each residential property (mm) 每個住宅物業的樓板(不包括灰泥)的厚度(毫米)
GREENWOOD TOWER 2 翠景閣第2座	Roof 天台	A1	Not Applicable 不適用	Not Applicable 不適用
		A3		
		A6		
		B1		
		B2		
		B5		
		B6		
		B8		

The internal areas of the residential properties on the upper floors will generally be slightly larger than those on the lower floors because of the reducing thickness of structural walls on the upper floors. (This does not apply to the residential properties in the Phase because the design of the Phase does not involve reducing thickness of structural walls of residential properties on the upper floors.)

因住宅物業的較高樓層的結構牆的厚度遞減，較高樓層的內部面積，一般比較低樓層的內部面積稍大。（不適用於期數內的住宅物業，因期數的設計並不牽涉住宅物業的較高樓層的結構牆的厚度遞減。）

NOTES:

1. The dimensions of the floor plans are all structural dimensions in millimeter.
2. Please refer to pages AL01-AL04 of this sales brochure for legend of the terms and abbreviations shown on the floor plan and the explanatory notes that are applicable thereto.

備註:

1. 樓面平面圖之尺規所列數字為以毫米標示之建築結構尺寸。
2. 平面圖中顯示之名詞、簡稱之圖例及其適用的附註，請參閱本售樓說明書第AL01-AL04頁。

FLOOR PLANS OF RESIDENTIAL PROPERTIES IN THE PHASE

期數的住宅物業的樓面平面圖

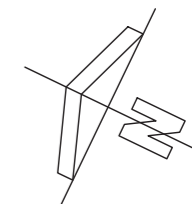
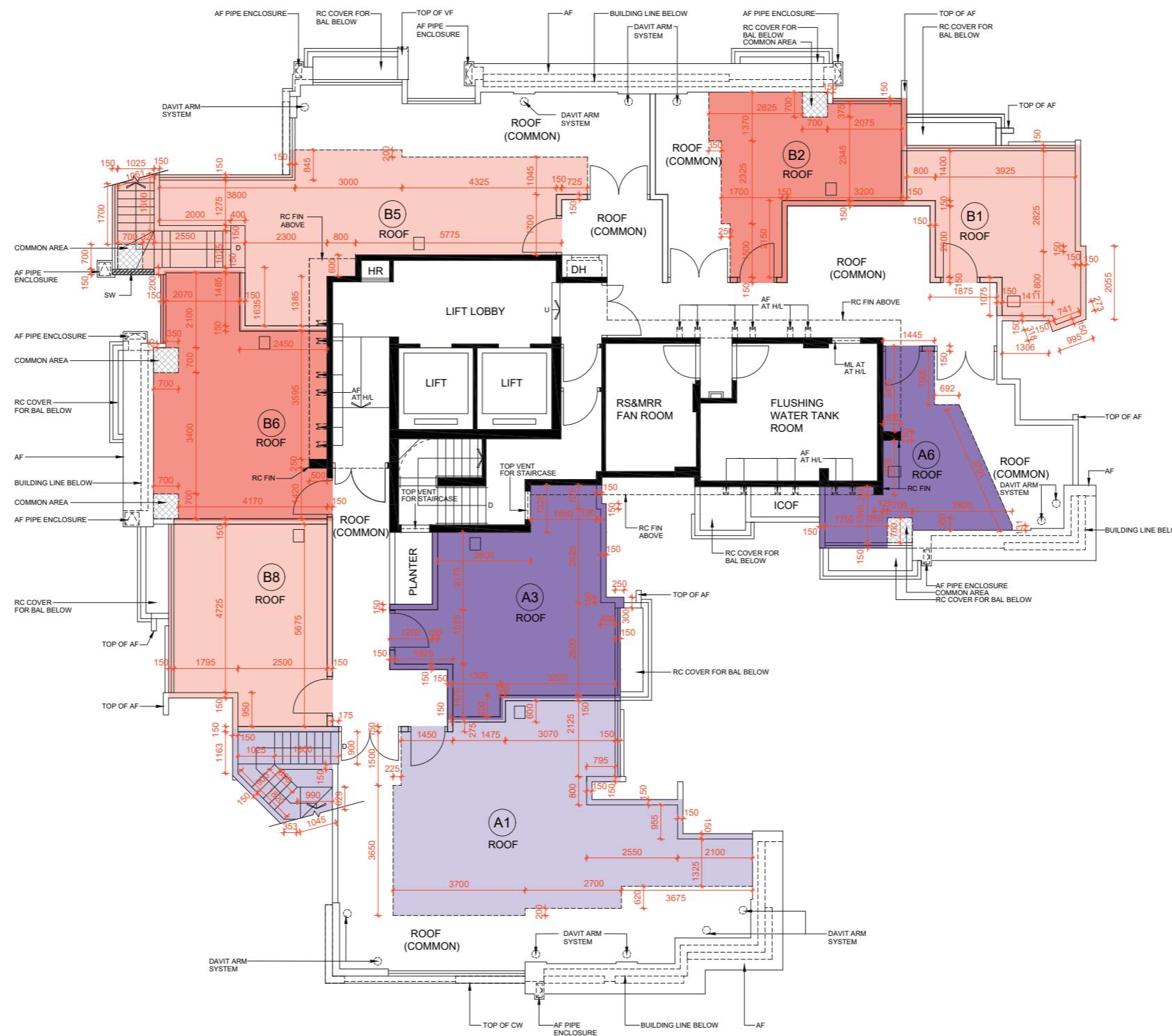

GREENWOOD TOWER 2 ROOF FLOOR PLAN
翠景閣第2座 天台平面圖

Scale 比例
0m / 米 5m / 米