

FLOOR PLANS OF RESIDENTIAL PROPERTIES IN THE DEVELOPMENT 發展項目的住宅物業的樓面平面圖

TOWER 1A AND TOWER 1B
(第1A座及第1B座)

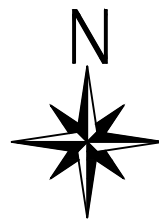

1. The dimensions of floor plans are all in millimeter.
2. The floor-to-floor height of each residential property in different locations on 5/F to 9/F is 3.000M. The floor-to-floor height of each residential property in different locations on 10/F is 2.700M, 2.800M, 2.900M, 3.000M, 3.100M, 3.200M and 3.300M.
3. The thickness of the floor slabs (excluding plaster) of each residential property in different locations on 5/F to 10/F is 125mm and 150mm.
4. The internal areas of the residential properties on the upper floors will generally be slightly larger than those on the lower floors because of the reducing thickness of the structural walls on the upper floors.
5. Please refer to Pages AL001 to AL002 of this sales brochure for remarks, legend of the terms and abbreviations shown in this floor plan.

1. 平面圖之尺規所列數字以毫米標示。
2. 5樓至9樓每個住宅物業的層與層之間的高度在不同位置為3.000米。10樓每個住宅物業的層與層之間的高度在不同位置為2.700米、2.800米、2.900米、3.000米、3.100米、3.200米及3.300米。
3. 5樓至10樓每個住宅物業的樓板(不包括灰泥)的厚度在不同位置為125毫米及150毫米。
4. 因住宅物業的較高樓層的結構牆的厚度遞減,較高樓層的內部面積,一般比較低層的內部面積稍大。
5. 樓面平面圖中顯示之附註、名詞及簡稱請參閱本售樓說明書第AL001至AL002頁。

SCALE 比例尺: 0M(米) 3.5M(米) 7M(米)

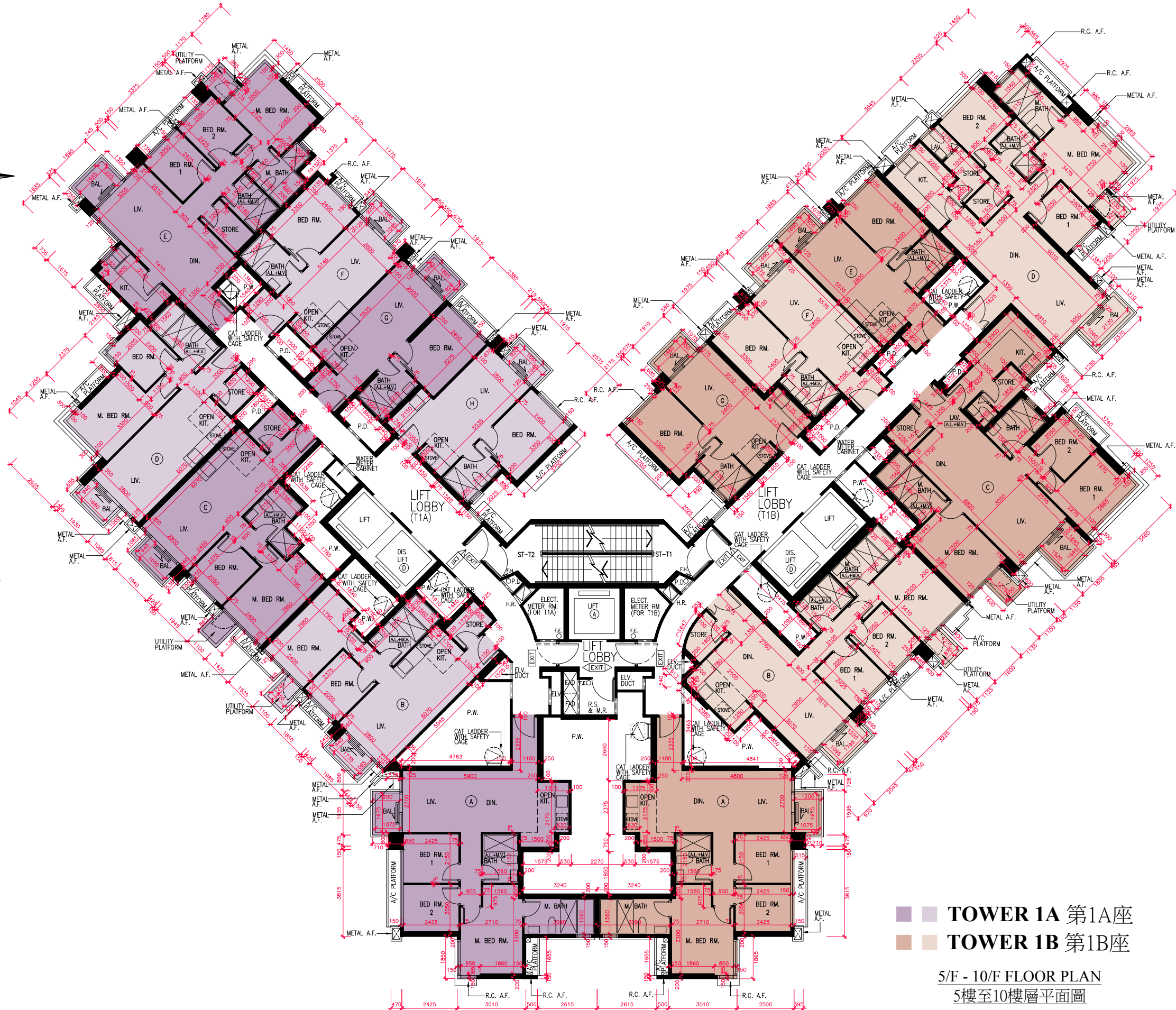

TOWER 1A 第1A座
 TOWER 1B 第1B座

5/F - 10/F FLOOR PLAN
5樓至10樓層平面圖